

District 5580 World Community Service (WCS) Matching Grant Application

FOR DISTRICT 5580 USE ONLY (once Grant is approved)

District Grant No. WCS-_____ Date Approved _____
District Grant Subcommittee Chair Signature _____
District Rotary Foundation Chair Signature _____

Explanation: Matching Grants support the humanitarian service projects of Rotary clubs and districts. In this section, describe in detail the humanitarian need your project will address, the intent of the project, how the project will be implemented, and how Rotarians will be directly involved in the project (involvement is required of both the host and international partners).

The purpose of this project is to construct a new 2-room school and compost latrines for the El Dormido community because the previous school was destroyed by Hurricane Agatha. The village / community (also called an Aldea) is 19 kilometers from Monterrico, Chiquimulilla in the Santa Rosa region of Guatemala. It is located in the Southern part of the country on the Pacific Coast. The community consists of 120 adults and 90 children. Currently the children are attending class in two make-shift classrooms (photos attached) of timbers tied together and a dirt floor.

This is a new region of the country to FM area (and D5580) Rotarians. We have not done any projects yet in this area. There is also a great need because they are small and far from the resources of the big city.

Please provide the name of the project site, the city or village, state or province, and country. **Provide a detailed map of the area or provide GPS (Global Positioning Site) coordinates.**

List multiple locations, if applicable.

Project site Aldea of El Dormido

City/Village Monterrico, Chiquimulilla

State/Province Santa Rosa

Country Guatemala

GPS coordinates (if no map) See attached Map at end

Provide name of ownership of property that structure is to be built on.

The people of El Dormido own the land. The previous school was not on stable land (which contributed to it being destroyed in the storm) so the government granted a new piece of land so the school could be rebuilt. The community of El Dormido owns this new land and the people will maintain the school upon completion.

Provide a blueprint/ detailed drawing of the proposed structure (Please attach a drawing).
Drawings are attached at end of document

Describe the project and the problem or need it will address, including the intended beneficiaries and how the project will benefit the community in need.

The Fargo-Moorhead Rotary Clubs and their D5580 partners will send Rotary two teams of volunteers from D5580 in 2011 in January, February to work side-by-side with locals on this project.

Currently the community has one teacher and with a new school the government will send a second teacher. The community will feel ownership in the project by contributing labor, therefore they will feel an obligation to maintain the structure. Rotarians from the U.S. will benefit greatly from the cultural sharing opportunity to meet and interact with the individuals who benefit from this school.

The latrines are important because the old ones were destroyed in the storm. They will be special compost latrines with a drying element, so there will not be an issue of non-use due to a strong odor from the heat.

Provide the estimated length of time needed to complete the project.

The estimated timeframe for project completion is 4-5 months. We realize that this could vary as the rainy season can impact working conditions and thus delay project completion.

Describe how the benefiting community will maintain this structure or project (financing of maintenance, etc) after grant funding has been fully expended and who will be responsible for sustainability of the structure.

The Aldea of El Dormido will assume ownership and will maintain the structure once completed. The locals take pride in their work and they know how important a good education is for their children.

Describe specific activities of the host and international partners in implementing the project.

The host partner is the Vista Hermosa Rotary Club in Guatemala City. Julio Grazioso is a past president and he is in his second year as International Director for this club. In the past we worked very closely and effectively with Desiree Sempee from 2003 to 2009. Desiree has continued her involvement in our projects through electronic communications and she is able to offer advice in finding much-needed projects and how to ensure a fair and accurate budget is presented for project proposals. Julio has a genuine compassion for finding projects to help the poor people of his country and he dedicates much of his free time to this purpose.

The El Dormido community will assume full responsibility for the future maintenance once this school project is complete.

What will the Rotarians who are members of the partner clubs do during the project? Please note that financial support is not considered active involvement. (See the Matching Grant application instructions for suggestions.)

Two teams of Rotarians will be traveling in January and February respectively to help in the construction of the schoolrooms. They also will take pictures to include in the final report to show Rotary's involvement in this project. The Rotarians will work with the locals and also play with the children who will ultimately benefit from the school.

Explanation: The host partner is the club or district in the project country. A committee of at least **three** Rotarians must be established to oversee the project. The primary project contact must be a member of the primary club identified below. The project committee must be composed of members of the sponsor Rotary club or NGO for club-sponsored projects or district for district-sponsored projects. The committee members must be committed for the duration of the grant process. Please provide the primary address for all committee members, as all District 5580 information will be sent to this address. It is highly recommended that the primary contact (who receives all information from District 5580) have an e-mail address to expedite communication

Primary Rotary Club/District/ or NGO

Club: Name and Number and/or: Vista Hermosa Rotary Club
NGO

District 4250 Country Guatemala

Primary Contact:

Name Julio Grazioso

Member ID

Club Vista Hermosa Rotary

Position International Service Chair

Address 7a. Avenida 3-74 Zona 9, Edificio 74 3er Nivel, Oficina 300

City Guatemala City

State/Province Postal code Country Guatemala 01014

E-mail Julio@presto.com.gt

Home phone (502) 5203-4041 (cell) Office (502) 2381-4000 Fax (501) 2381-4040

Project Contact #2:

Name Carlos Rafael Rosales

Member ID

Club Vista Hermosa Rotary

Position President

Address Calzada Aquilar Batres 34-70, zona 14. 4o. Nivel

City Guatemala City

State/Province Postal code Country Guatemala 01011

E-mail Carlos.Rafael.Rosales@gmail.com

Home phone (502) 4212-8188 Office (502) 2327-8500 Fax (502) 2327-8585

Project Contact #3:

Name Enrique Rosas

Member ID

Club Vista Hermosa Rotary

Position President Elect

Address 18 Calle 13-08, zona 7. Colonia San Ignacio

City Mixco
State/Province Postal code Country Guatemala 02007
E-mail Enrique_Rosas@transam.com.gt
Home phone (502) 5403-0018 (cell) Office (502) 6636-0859 Fax (502) 6636-0860

Explanation: The international partner is the club or district outside the project country. In this case, the international partner would be a club in District 5580 or District 5580. A committee of at least **three** Rotarians must be established to oversee the project. The primary project contact must be a member of the primary club identified below. The project committee must be composed of members of the sponsor Rotary clubs for club-sponsored projects or district for district-sponsored projects. The committee members must be committed for the duration of the grant process. Please provide the primary address for all committee members, as all District 5580 information will be sent to this address. It is highly recommended that the primary contact (who receives all information from District 5580) have an e-mail address to expedite communication.

Primary Club/District

Club Fargo-Moorhead (FM) AM Rotary Club
Club ID 27847
District 5580
Country USA

Primary Contact #1:

Name Jennifer Miller
Member 6889672
Club FM AM Rotary
Rotary position International Director
Address 3201 20th St. S. #133
City Fargo
State/Province Postal code Country ND 58104
E-mail jenlyn.miller@gmail.com
Home phone 701-367-3981 Fax (none)

Project Contact #2:

Name Keith Brokke
Member ID 1813144
Club FM AM Rotary
Rotary position International Committee
Address 42754 Engstrom Beach Road
City Dent
State/Province Minnesota Postal code 56528 Country USA
E-mail kbrokke@borderstatespaving.com
Home phone (218) 371-9243 (cell) Office (701) 237-4860 Fax (701) 237-0233

Project Contact #3:

Name David Brian Manning
Member ID 6013490

Club FM AM Rotary
 Rotary position Past President
 Address 1915 4th Street S.
 City Moorhead
 State/Province Minnesota Postal code 56560 Country USA
 E-mail davidbrianmanning@gmail.com
 Home phone (218) 291-0679 Office (701) 476-8334 Fax

*Explanation: Official exchange rates can be found at
www.rotary.org/newsroom/downloadcenter/support/rates.html (Please use the most recent rate)*

ITEMIZED BUDGET TO BE FILLED OUT BELOW:

Budget for Classrooms

No.	Unidad media	Descripción	Cantidad	Costo por unidad	Costo total
1	Quintal	Hierro de 3/8"	25	Q 300.00	Q 7,500.00
2	Quintal	Hierro de 1/4"	7	Q 300.00	Q 2,100.00
3	Quintal	Alambre de amarre	1	Q 900.00	Q 900.00
4	Libra	Clavo de 3"	50	Q 9.00	Q 450.00
5	Libra	Clavo de 4"	30	Q 9.00	Q 270.00
6	Libra	Clavo de 8"	15	Q 9.00	Q 135.00
7	Unidad	Techo de paja, tipo rancho	1	Q20,000.00	Q 20,000.00
11	Unidad	Tornillos 4"	1000	Q 1.00	Q 1,000.00
12	Unidad	Block	2,750	Q 3.60	Q 9,900.00
13	Sacos	Cemento	175	Q 68.00	Q 11,900.00
14	Unidad	Tablas pino	24	Q 80.00	Q 1,920.00
15	Unidad	Camionadas arena	6	Q 1,100.00	Q 6,600.00
16	Metro Cubico	Piedrin	10	Q 200.00	Q 2,000.00
17	Unidad	Puertas	2	Q 1,200.00	Q 2,400.00
18	Unidad	Ventanas	4	Q 1,200.00	Q 4,800.00
		Sub Total			Q 71,875.00
		Imprevistos e inflación			Q 7,187.50

		Total	Q 79,062.50
--	--	--------------	--------------------

Budget for Compost Latrines with Hand Pump

No.	Unidad media	Descripción	Cantidad	Costo por unidad	Costo total
1	Unidad	Block	500	Q 3.60	Q 1,800.00
2	Unidad	Laminas	10	Q 95.00	Q 950.00
3	Unidad	Costaneras 12"	3	Q 200.00	Q 600.00
4	Unidad	Tornillos 4"	25	Q 1.00	Q 25.00
5	Libra	Alambre de Amarre	25	Q 9.00	Q 225.00
6	Unidad	Cuartones, (parales 3"x4"x6")	2	Q 100.00	Q 200.00
7	Libra	Clavo 3"	10	Q 9.00	Q 90.00
8	Libra	Clavo 4"	5	Q 9.00	Q 45.00
9	Bolsa	Cemento	50	Q 68.00	Q 3,400.00
10	Quintal	Hierro de 3/8"	4	Q 300.00	Q 1,200.00
11	Quintal	Hierro de 1/4"	3	Q 300.00	Q 900.00
12	Quintal	Hierro de 1/2"	1	Q 300.00	Q 300.00
13	Camionada	Camionadas de arena	3	Q 1,100.00	Q 3,300.00
14	Metro Cubico	Piedrin	5	Q 200.00	Q 1,000.00
15	Unidad	Tablas	12	Q 80.00	Q 960.00
16	Unidad	Accesorios	1	Q 550.00	Q 550.00
17	Unidad	Tasas	2	Q 500.00	Q 1,000.00
18	Unidad	Tinaco	1	Q 780.00	Q 780.00
19	Unidad	Bomba	1	Q 500.00	Q 500.00
		Sub total			Q 17,825.00
		Inflación e imprevistos			Q 1,782.50
					Q 19,607.50

Subtotal all items in country currency: Q98,670

Exchange rate used US\$1= 8.1 **

Total in U.S. dollars: \$12,182

Explanation: Clearly list all financing in U.S. dollars noting which funds will be contributed in cash and which will be contributed from District 5580 WCS funds. Use of WCS must be approved by the Grants Subcommittee and authorized by the district Rotary Foundation committee chair. The host club or district must provide at least \$100

in cash and it is highly recommended that they match as much as possible with “in kind” donations of sweat equity whenever possible.

NOTE: A project bank account must be established in District 5580 or Host country before WCS grant funds will be distributed. When established and total club/cash contributions are in the fund, the WCS grant matching funds will be sent directly to the project bank account.

Host Club (project country) cash donation: \$100 USD from Vista Hermosa RC

D5580 Rotary Club(s) or District outside the project country

Cash (US\$) \$6041

Subtotals, Cash

TOTAL Cosponsor contributions

Total funds requested from District 5580 WCS fund \$6041

Additional outside funding:

(not matched by WCS fund)

Total project financing: \$12,182 USD

(must equal budget on page 4)

Explanation:

Before an application is submitted to District 5580, project partners should discuss various planning details. The questions below are a guide to aid project planning. Note that a Rotary club/district or Rotarian may not own anything purchased with grant funds.

Identify who will own equipment and maintain, operate, and secure items purchased with grant funds. (A Rotary club or Rotarian cannot own equipment.)

Will training in use and maintenance of technical equipment be provided? If so, who will provide training?

Is software necessary to operate any items? If so, has software been provided? Indicate what arrangements have been made for customs clearance if items will be purchased and shipped from outside the project country.

Provision of plumbing and electrification to structures where people live or work may be funded with WCS funds. Have plumbing or electrification for equipment and appliances in existing buildings (hospitals, schools, libraries, orphanages, etc.) been considered and funded?

Explanation: Authorizations ensure that both partners are aware of, and interested in, pursuing the described project. By signing below, the current club presidents for club-sponsored projects and current district grants subcommittee chairs for district-sponsored projects, as well as the committee members, agree to the criteria listed and affirm their support of the project.

All Rotary clubs, districts, and Rotarians involved in this project are responsible to District 5580 for the conduct of the project and its subsequent reporting. The signatures of all involved parties confirm that they understand and accept responsibility for the project. Parties may either sign this page or submit a separate letter of commitment.

By signing below, we agree to the following:

- All information contained in this application is, to the best of our knowledge, true and accurate, and we intend to implement the project as presented in this application.
 - The club/district agrees to undertake this project as an activity of the club/district.
 - We ensure all cash contributions (as detailed in Project Financing) will be forwarded to the project bank account after approval of the grant.
- District 5580 may use information contained in this application to promote the project by various means such as the 5580 website, the district newsletter and other publications of the district.
- The partners agree to share information on best practices when asked, and District 5580 may provide partners' contact information to other Rotarians who may wish advice on implementing similar projects.
 - To the best of my knowledge and belief, except as disclosed herewith, neither I nor any person with whom I have or had a personal or business relationship is engaged, or intends to engage, in benefiting from District 5580 grant funds or has any interest that may represent a potential competing or conflicting interest.

A conflict of interest is defined as a situation in which a Rotarian, in relationship to an outside organization, is in a position to influence the spending of District 5580 grant funds, or influence decisions in ways that could lead directly or indirectly to financial gain for the Rotarian, a business colleague, or his or her family, or give improper advantage to others to the detriment of District 5580.

(NOTE: Any and all exceptions must be explained in an attached statement.)

Host Partner

President (club-sponsored)
District grants subcommittee
Chair (district sponsored)

Gilberto Enrique Rosas

Name:(print) _____

Title: _____ President _____

Rotary Club: Vista Hermosa

District #: _____ D4750 _____

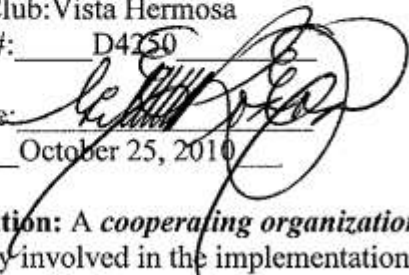
Signature: 

Date: _____ October 25, 2010 _____

International Partner

Club president (club-sponsored)
District Grants subcommittee chair
(district sponsored)

Name:(print) _____ Sylvia Lunski _____

Title: _____ President _____

Rotary Club: _____ FM AM Rotary _____

District #: _____ D5580 _____

Signature: 

Date: _____ Oct 25, 2010 _____

Explanation: A *cooperating organization* (for example, an NGO) is an organization that is directly involved in the implementation of the project, offering technical expertise and project coordination.

A *benefiting entity* is the recipient of goods or services and is not considered a cooperating organization.

If this project involves a cooperating organization (neither a Rotary club nor the beneficiary of the project), provide the following:

Name of organization: _____

Street Address: _____

City, State/Province Postal code Country: _____

Office phone Fax: _____

E-mail: _____

Web address if available: _____

Also, have the project contacts provide the Project Contact information as listed above.

In addition to the above, the following must be attached:

- Letter of participation from cooperating organization that specifically states:
 - Its responsibilities and how it will interact with Rotarians
 - The organization’s agreement to cooperate in any financial review of the project.

Explanation: Although both partners are responsible for completing the interim and final reports, District 5580 requires that one partner take primary responsibility for submitting the final report to District 5580. It is recommended that the primary project club in District 5580 take that responsibility.

"By signing below, our club accepts primary reporting responsibility."

Print name: Jennifer Miller International Service Chair

Signature: 

Rotary club: PM AM Rotary

District: D5580

Before submitting your Matching Grant application, please take a moment to review this checklist.

If you have any questions or concerns, please contact the Humanitarian Grant Coordinator for the project location.

- Does the project meet **all** grant policies and guidelines?
- Does the project description clearly state how the project will assist those in need?
- Are the activities of the host and international partners clearly explained?
- How will Rotarians be actively involved in the project?
- Have both the host and international partners created committees to oversee the project?
- Are these individuals correctly listed on the application with their complete contact information?
- Is a detailed, itemized budget included in the application?
- Is ownership of the property the structure will be located on included?
- Is a blueprint/detailed drawing of the structure included?
- Are all partner contributions listed in the application noting which are from the WCS fund?
- Have the club presidents from the host and international partner provided their authorizing signatures?

If a cooperating organization is involved, are the following letters included with the application:

- Letter from the organization specifically stating its responsibilities, how it will interact with Rotarians, and agreeing to cooperate in any financial review of the project
- Has the District Grants Subcommittee chair from District 5580 certified the application as complete and eligible?

*****Have the partners made copies of all documents for their files prior to submitting them to District 5580?**

*****Complete applications should be sent to:**

Grants Subcommittee Chair, District 5580

Contact information on District 5580 Website: www.clubrunner.ca/5580



Club Rotario Vista Hermosa
Guatemala City
Año 2010 – 2011

27 October 2010
Ms. Jennifer Miller
3201 20th St. S. #133
Fargo, ND 58104
USA

Dear Jennifer,

Greetings from the Vista Hermosa Rotary Club in Guatemala City of District 4250 with Rotary International.

I appreciate your continued interest in working on projects to benefit the poor people of Guatemala. I would like to invite your club, Fargo-Moorhead AM Rotary of District 5580, to partner with us again this year to work on the following projects.

- 1 – To reconstruct a school in the Aldea of El Dormido located in Monterrico- Chiquimulilla, Santa Rosa, Guatemala.
- 2 – To construct a new water system in the community of Caserio Xesiguan located in Santa Apolonia, Chimaltenango, Guatemala.
- 3 – To repair the water distribution system at Las Tablitas in the Las Flores area, which was visited by the Engineers without Borders group in 2009.

The contact person in our club is:

Julio Grazioso

In an anticipated way, we thank you for your collaboration with other Rotary Clubs in your area and District 5580 to help the people of Guatemala with past and future projects.

Sincerely yours in Service,

Gilberto Enrique Rosas Estrada
President – Club Rotario Vista Hermosa, D4250
2010-2011



Este es el departamento de Santa Rosa en Guatemala



1. Cuilapa,
2. Barberena,
3. Santa Rosa de Lima,
4. Casillas,
5. San Rafael Las Flores
6. Oratorio,
7. San Juan Tecuaco,
8. Chiquimulilla,
9. Taxisco,
10. Santa Maria Ixhuanán
11. Guazacapán,
12. Santa Cruz Naranjo,
13. Pueblo Nuevo Viñape,
14. Nueva Santa Rosa

The El Dormido community is only 19 kilometers from Monterrico down a dirt road. The Agatha Hurricane changed the topography of the village and destroyed the school. Currently the students are learning in a make-shift classroom with dirt floors. We would like to build two sturdy classrooms for a better learning environment. Currently the community has one teacher, but if they get this school, the government will send a second teacher. The project includes two compost latrines with a drying element – this will prevent issues of non-use due to heat-related odor.



CLASSROOMS

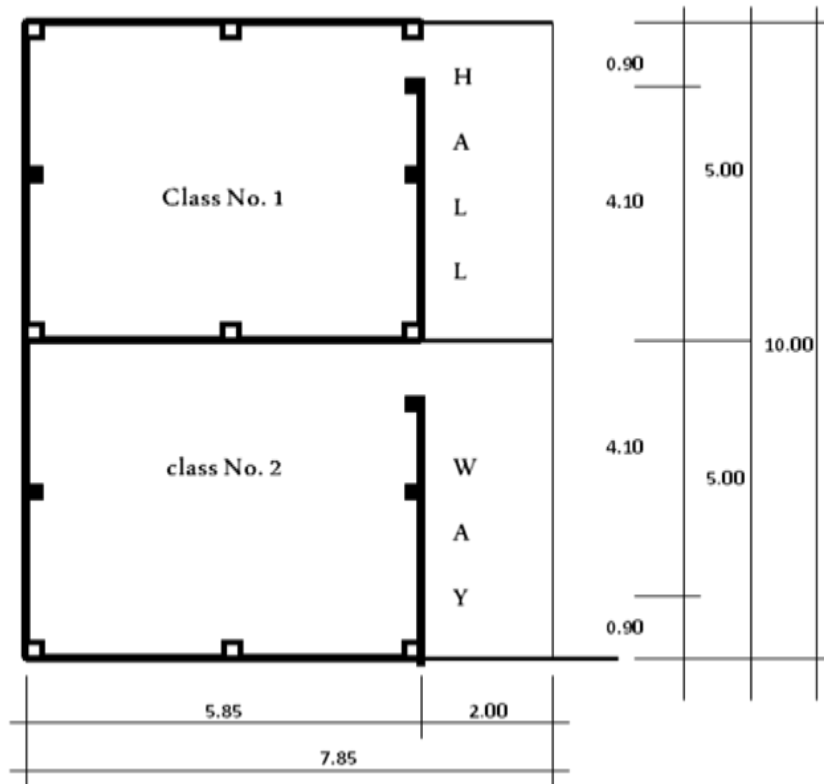

Measures In Meter

SIDE VIEW

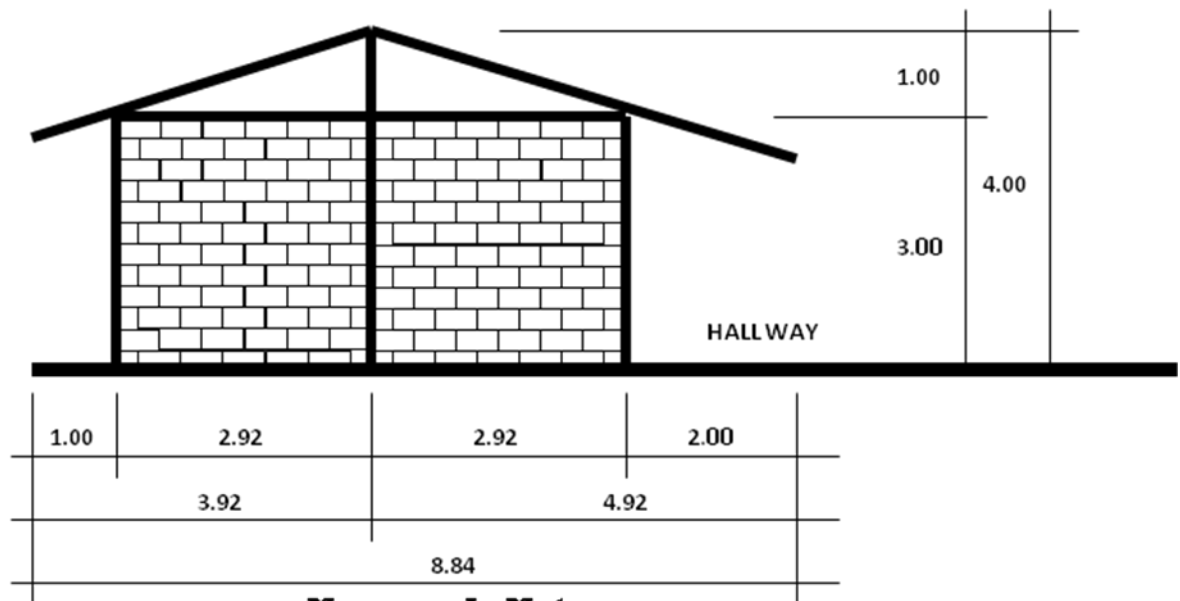

Measures In Meter