

Rotary



BE THE INSPIRATION

2018-2019

## UPCOMING PROGRAMS

**Jan 24th**  
Rutledge, Jamie, Johnny & Randy  
Plano Pioneers Forum

**Jan 31th**  
TBD

**Feb 7th**  
NO NOON METING

"BRINGING IN THE  
NEWYEAR"



ENDPOLIONOW

## JANUARY BIRTHDAYS

Little, Pamela	Jan 04
Via, Jo	Jan 05
McWhorter, David	Jan 15
Aris, Jerry	Jan 17
Brodhead, John	Jan 20
Hernandez, Paul	Jan 25



## WINTER Weekly

Volume 266, Issue 331, January 24th, 2019

# Reader

The Plano Rotary Club  
www.PlanoRotary.com

## Good Management Heritage

**S**QUIRRELS in our attic interrupted the proceedings throughout. They were roofers with nail guns at the ready, pounding in a new roof at *Gleneagles*. Nevertheless, our dedicated crew belted out a credible meeting in spite of the obstacles.



**Carolyn the Petite** competed with the hammers to open the meeting at 12:15, assigning **Blair Ritchey** to pray and **Kelly Palmer** to pledge. No one was credited with greeting, so **SERGEANT NANCY** was called to welcome Visiting Rotarians and Guests.



**Howard Matson** led the parade with two guests, **Dr. Rebecca Good** and **Staci Weaver**, a Director of Global Development, here to "partner with the Rotary Club of Dallas," oops, he meant *Plano*.



**Janelle Twyford-Silvis** (today's photographer) introduced guest **Mavis Everett**, a business consultant. **Joe Camarena**

welcomed **Peggy Fenwick**, an *Allstate* rep from the *Shops of Legacy*. Finally, **Rick Horne** bade us welcome his climbing buddy and fellow congregant at *Christ Church*, **Eric Eisenhard**.



Our Visiting Rotarian, **Friday Ekpe**, came all the way from *Ilesa Hilltop Rotary* in Ilesa, Nigeria. He was presented with our Club Banner and a round of applause.

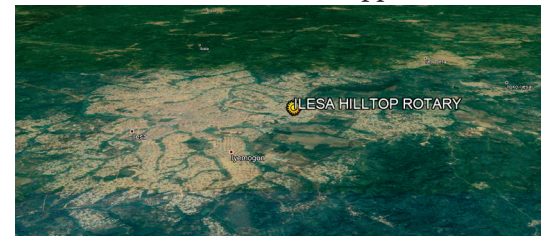

**NANCY** hunted around for someone to embarrass and discovered him in the Prodigal Son Category, **Martin Jackson**. "Glad you're here today," she jibed at the perennially AWOL member. Mother-in-Law **Jo Via** countered, "No, we're not!" Martin said he was happy to be sitting next to wife **Jessica**, but distressed to be placed so close to Jo.

**NANCY** rescued him from that faux pas by beginning the interview:

- 1<sup>st</sup> car: '86 Dodge "from *Huffines*."
- Favorite band: *Blackberry SMOKE*
- Weirdest job-related incident: "installing a copier while the place was being robbed. I said, 'Give me a gun or I'm leaving.'"

continued on page 2



- TARDIS moment: “*Hanging out on Nantucket with **Larry (FLASH)**.*”
- Tattoo? **Charles Milby** and Martin had “a few beers” with Loni Anderson and decided to get tattoos “done by ‘**Shakey Bob**,’ but Bob was too drunk,” so they settled for someone else. Charles’ was done first, and “Martin’s looked like a woodpecker.”
- Asked to name his favorite thing about his Mother-in-Law, Martin redeemed himself with “the list is too long.”



### • **Blackberry SMOKE**

Sainted Editor was called up to receive his 17-year Rotary Attendance Pin. Chris also presented the Club with a banner from the Budapest Duna Rotary. “Duna is Hungarian for ‘Danube,’” Chris explained. Then he continued on, unnecessarily recounting his rejection by another Rotary venue (Milan, Italy) for failure to show up in coat and tie!

**Ric Kasmiskie** received applause for his 24-year pin!



Kelly Palmer had a brag. (That’s subject to a \$5 fine at most clubs, Kelly.) Son **Jessie** is finishing *West Point* and garnering beaucoup scholarship bids: *Cambridge’s* Churchill Scholarship, a *Stanford University* Scholarship, even a **Barry Goldwater** Scholarship. Kelly swears “it’s not genetic,” but his wife has accused him of “fooling around.”

**Olin Jaye** rose ostensibly to introduce the speaker but actually to razz Kelly, whom he asked, “Do you have visa problems to visit [Jessie]?” “No,” Kelly responded, “I go through Mexico.” Well then, Olin surmised, they would arise on the return journey.

Olin then introduced **M’Lou Hyttinen**, the Executive Director of the **HERITAGE FARMSTEAD MUSEUM** in Plano.

[MLou@heritagefarmstead.org](mailto:MLou@heritagefarmstead.org)

Raised (he left out “in a log cabin” as is his usual wont) in Jackson, MS, she joined the rest of the “Baylor mafia,” which constitute the majority of our elected officials. She joined the Real Estate Council and is “friends with Jamee Jolly, but we won’t hold that against her.” Then he threatened to mention something about “getting 🐛faced,” but decided against it as “inappropriate.”

“Gimme a sec to get my tech goin’,” her 1<sup>st</sup> words.



She thanked us for the invitation (extended at the last minute when another speaker canceled, so we should be thanking her) and said that though she respects all Plano Rotaries, she has a special place in her heart for this one, being the largest and housing “so many friends.”

M’Lou said she “grew up on a farm in Garland” where she “raised quarter horses,” so the **HFM** is “like coming home.” No quarter horses there but they did recently “have a chicken incident.” She declined to elaborate.



**HFM** is now a 4-acre site, down from its original 365 acres, so “blink, and you’ll miss it” at its 15<sup>th</sup> & Custer location. (Well, actually 15<sup>th</sup> and Pittman.) The Museum is into “preservation and sustainability,” keeping the “original buildings as they were laid out,” but renovating them in their original style.

Many of Plano’s old Victorian dwellings are now gone, “but our residents never changed” theirs. The **Farrells** owned the place, and when wife **Ammie** divorced **Hunter**, she retained the property. They were predominantly a sheep ranch, carrying 400 head. (Ric Kasmiskie, in a surfeit of helpfulness, moved the lectern away from the screen, upsetting the [connected] projector into the bargain.) M’Lou promised to keep stories about Olin and the sheep to herself.

The original farm was purchased by the City, which still owns it; **HFM** “provides the preservation services.” The farm is 127 years old; “our goal is another 200 years!”

They’re working on a **Vision Plan**; it’s going to involve recreating the “openness of the farm. We’ll recreate one of the barns down by [Pittman] creek.” The group’s **Passion** is “excellence in history, in Agricultural Education” but also **Fun**. It teaches 10K kids annually, immers-



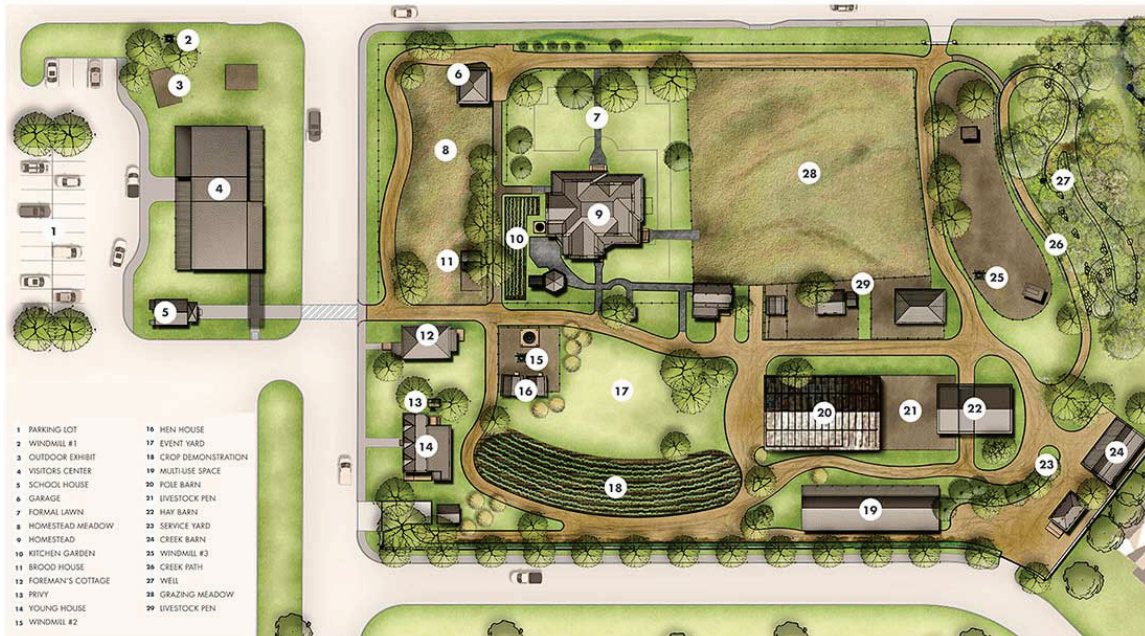

ing them in farm history because “kids these days don’t have that as history.” Funding problems have prevented them from reaching all of PISD schools, but they’ve included other districts and home schools as well. This season’s field trips are already sold out.

We adults are not forgotten. We get Fish Fries, lecture programs, a BBQ & Beer Fundraiser, and an Adult Egg Hunt. (What’s an adult egg? A contradiction in terms?) Apparently, adults hunt eggs in the dark, “inspired by Olin,” she claimed. It raised over \$10K from the 400 tickets sold.

**HFM** offers standing and temporary exhibits and serves as a “beloved community venue” for weddings, graduation parties, memorial services, and an annual Plano Fire Department Picnic!

It manages livestock including sheep, goats, pigs, chickens, turkeys, and **Pancho** the Donkey. 500 volunteers from churches and other institutions, including *Toyota Corp* oversee everything, including a gift shop. All are managed by a dedicated staff of seven.

The City of Plano offers funding from the Hotel/Motel Tax via the Culture Commission. The venue hosts 35K visitors a year. Attendance and funding are up at 30% & 50%, respectively. “*The Future is Bright.*”

After a bid for us to become members (application flyers were on the tables) and for us to help connect **HFM** to others, M’Lou took questions.

**Janis Allman** asked whether there were any great-grandsheep among the herd. M’Lou said the farm hasn’t the breed that **Ammie Wilson** had; they have the Hampshire breed.

Janis asked after **Chicken Nugget**, the rooster who had died last week. M’Lou said that was the incident, a weasel wiped out the hen house for fun.

Ric Kasmiskie asked how the museum is certified. M’Lou said a peer investigation awarded **HFM** its accreditation. And that wasn’t compromised by Ammie Wilson’s reputation as a poker madam, loathed by the wives of the men she played with.

**Carolyn the Petite** thanked her for her



flexible schedule, cautioned Board members to stay after the meeting, led us in the Four-Way Test, and belled us out at 1:05.



## Plano Rotary Club Board of Directors 2018-2019

### President

Carrolyn Moebius

### President Elect

Jeff Beckley

### Secretary

Tamara Dreger

### Treasurer

John Caldwell

### Past President

Rick Horne

### Sergeant at Arms

Nancy Humphrey

### Membership Chair

Howard Matson

### Public Relations Chair

Sara Akers

### R.I. Foundation Chair

Johnny Lewis

### At Large

Alex Johnson

Maria Mott

Roy Reeves

Jason Kramer

Olin Jaye

Sam Grief

### Business Secretary

Karen Sheldon

### Bulletin Editor

Dr. Chris Parr

### Bulletin Photographer

Mike Booher

### Bulletin Designer

Brandon Kessler

Alphagraphics

### Printing by Alphagraphics

Thank you Kenny Wilson

### The Plano Rotary Club

P.O. Box 864316

Plano, TX 75086

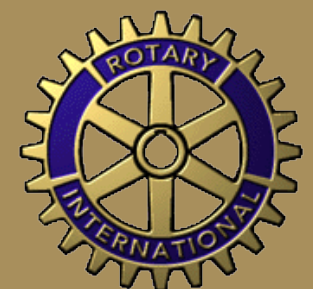

## Guests & Visiting Rotarians

### Guest

Rebecca Good  
Staci Weaver  
Mavis Everett

Peggy Fenwick  
Eric Eisenhard

### Visiting Rotarian

Friday Ekpe

### Guest of

Howard Matson  
Howard Matson  
Janelle Twyford-Silvis  
Joe Camarena  
Rick Horne

### Home Club

Hilltop Nigeria

## Proposed Member

Members please  
bring a guest with  
a serving heart



# Support Our Advertisers



**ACE  
FENCE-DFW**

**Pam Little**

(972) 578-5775  
Fax (972) 578-1005

pam@acefences.com  
1400 Capital Ave.  
Plano, TX 75074

"a fence to you,  
a reputation to us."



**David Allison**

1214 Avenue K  
Plano, TX 75074

972-423-0434  
www.allisons.com

**alphagraphics**

increase your reach

**KENNY WILSON**  
OWNER

**Plano**  
Phone: 972.867.9216  
us408@alphagraphics.com

**Richardson**  
Phone: 972.234.3033  
Fax: 972.231.6968  
us103@alphagraphics.com



**Casey W. Stewart**  
Regional Market President

972.309.0001 ext. 5937  
214.863.5937 direct  
214.863.6160 fax  
caseystewart@anbtx.com

**Plano Bank Center**  
1101 E. Plano Parkway, Suite E  
Plano, TX 75074

**Allen Banking Center**  
720 S. Greenville  
Allen, TX 75002  
www.anbtx.com



**ROY L. REEVES**  
Attorney

Ph. 972-596-4000  
Fx. 972-755-8726

**REEVES LAW FIRM, P.C.**  
Adoption, Child Custody & Divorce

1400 Gables Court  
Plano, TX 75075

Roy@reevespc.com  
www.reevespc.com



www.huffines.net

**HUFFINES**  
CHEVROLET

1001 Coit Rd @ Plano Pkwy  
Plano

(972) 867-4000

**PLANO**

**HUFFINES**  
HYUNDAI

909 Coit Rd @ Plano Pkwy  
Plano

(972) 867-5000

**HUFFINES**  
CHRYSLER Jeep  
DODGE RAM

4500 W. Plano Pkwy @ Ohio  
Plano

(972) 867-6000

All Service, Body and Parts Departments Open All Day Saturday

**J. Marc Lewis & Associates**  
CORPORATE AND PERSONAL TAXATION

J. Marc Lewis JD, LL.M., EA  
Enrolled to practice before the IRS

Lakeside Commons  
5045 Lonmar Drive  
Suite 280  
Plano, TX 75093

marclinc@airmail.net  
Tel. (972) 618-8224  
Fax (972) 618-2021



**RICARDO KASMISKIE**  
Realtor®

Office: (972) 732-6000  
Fax: (972) 732-6003  
eFax: (972) 468-7547  
Mobile: (972) 743-5324  
ricardokasmiskie@kw.com  
www.theonestotrue.com

**KELLER WILLIAMS**  
REALTY

18383 Preston Road, Suite 150  
Dallas, TX 75252

Each Office Independently Owned and Operated

**Bell & Valente**  
Wealth Services  
A Limited Liability Company

**Kirk Bell**  
Managing Partner, B&V, LLC  
Financial Advisor, RJFS

2500 Dallas Parkway, Suite 560  
Plano, TX 75093  
(972) 403-1025  
(972) 403-1063 (fax)

kirk.d.bell@raymondjames.com  
www.bellvalente.com

Securities offered through

**Raymond James Financial Services, Inc.**

Member FINRA/SIPC.

Bell & Valente Wealth Services, LLC is not a broker/dealer.



**Together We Can!**

**Event Chairs:**

**Brielle Pogue**

Pogue Entertainment Group

**Liffort Hobley**

Dallas Chapter President,  
NFL Alumni Association

**CUISINE FOR A CURE**

**SUNDAY, MARCH 24th, 2019**

Café Intermezzo at  
Shops at Legacy in Plano  
**5:30-8:30pm**



Progressive Dinner, Drawing, and Giveaways

with proceeds Benefiting

**Plano Children's Medical Clinic  
Health Services of North Texas**

**Tickets: \$125**

For information contact Larry Bisno lbisno@plano-cmc.org or 972-322-5754

