



Growing Hearts Across the World

100 Years of Rotary Service In Our Region

In 1919, a group of area citizens formed the Rotary Club of La Crosse...the first chapter of Rotary in the region. Throughout the years, Rotary was expanded to include: Rotary East, Valley View, La Crescent, Onalaska, Onalaska Hilltoppers, Caledonia, Holmen and Rotary After Hours. Today, these clubs have more than 520 members. In addition, there are seven high School Interact Clubs with more than 140 active members. The Interact Clubs are at Central, Logan and Aquinas in La Crosse, as well as Onalaska, Holmen, West Salem and Caledonia. All of these clubs operate independently as well as through the combined efforts of the Rotary Works Foundation. But they all exemplify the values of Rotary...Service Above Self!

Serving the Community and Across the World

The list of local Rotary projects, large and small, is numerous. A small sample includes: Rotary Lights, Kids Coulee, Moon Tunes, the Brain Game, iFeed as well as numerous scholarship and charitable events. On the global stage, area Rotary Clubs supported Polio Plus and projects in Russia, Brazil, Central and South America, Uganda, Romania, India and Cameroon. In addition, there have been well over 100 international student exchanges representing more than 30 nations. It is simply not possible to provide a complete list that reflects the true centennial impact of Rotary!

Developing a Landmark Garden...a Collaboration

In celebration of 100 years of Rotary in our region, Rotary is partnering with the International Friendship Gardens, the La Crosse Friends of Cameroon and the City of La Crosse to develop a garden in honor of the Sister City relationship between La Crosse and Kumbo, Cameroon. The effort is called Growing Hearts Across the World. It is indeed fitting that this will be a collaborative effort. The garden will be located in Riverside Park in La Crosse, adjacent to the International Friendship Gardens, in a prominent location where the Mississippi, Black and La Crosse Rivers meet. The attractive garden design will reflect the culture of Cameroon and will be "visitor friendly" with ample seating in an overlook setting. Community donor support is being sought to develop the garden.

Hearts to Schools

In addition, donors will have an opportunity to young people in Cameroon through the Hearts to Schools effort. Donors to Hearts to Schools will have a small portion of their contribution support the maintenance of the garden, with 90% of these targeted funds providing books, iPads and laptops for rural schools in Cameroon.

Your Help is Needed

Donations to the **Growing Hearts Across the World** can be made to:
Rotary Works Foundation
P.O. Box 1571
La Crosse, WI 54602-1571

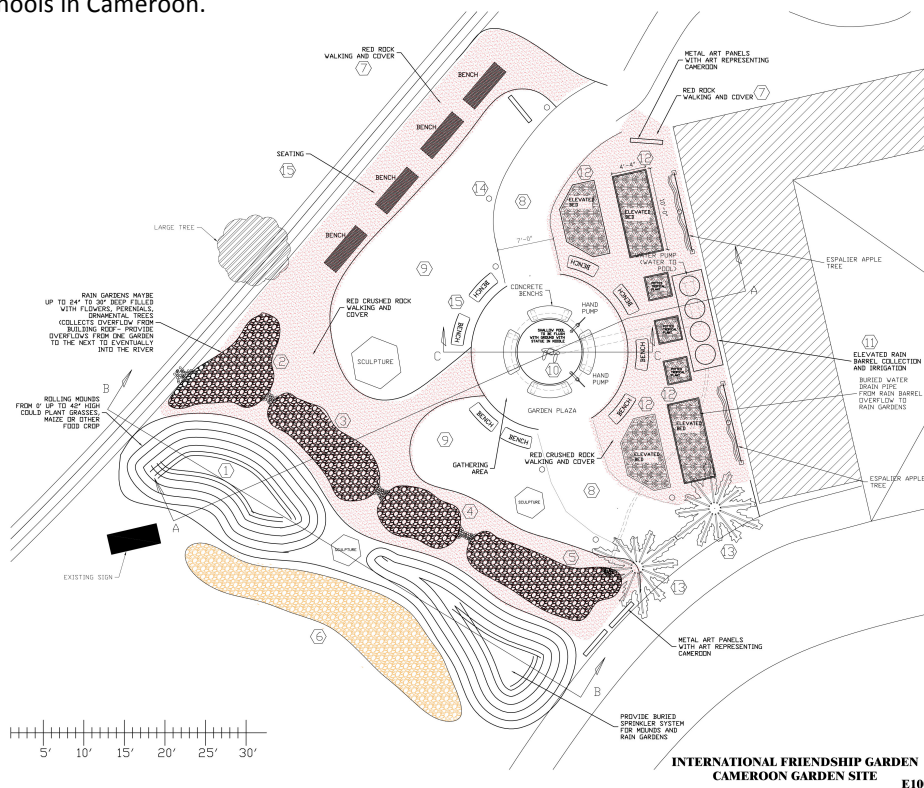

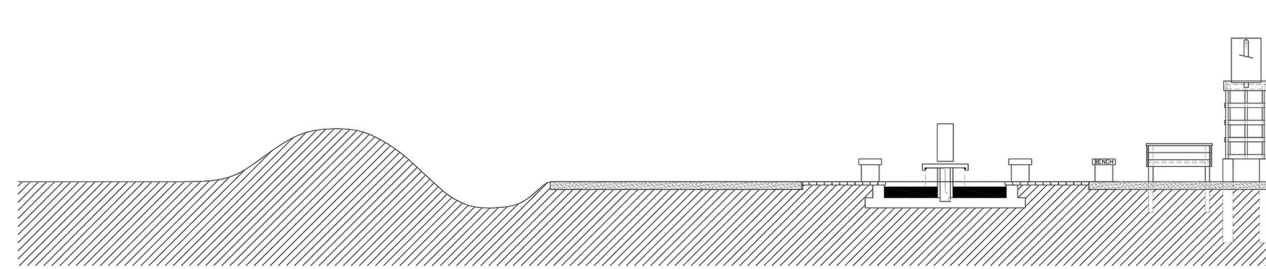

SECTION A-A

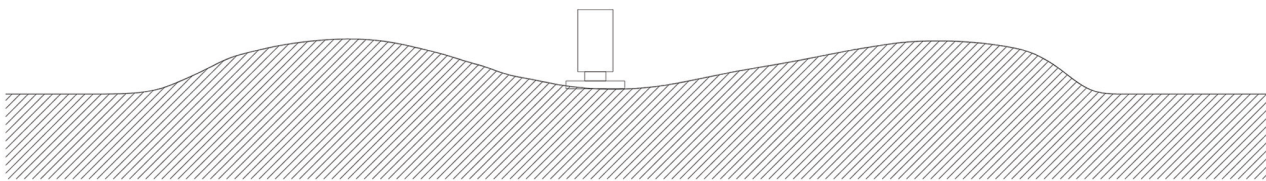

SECTION B-B

INTERNATIONAL FRIENDSHIP GARDEN
CAMEROON GARDEN SITE E101

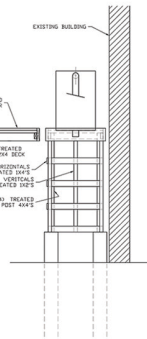
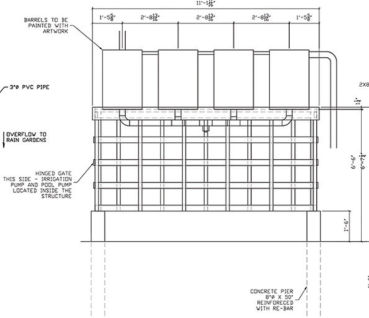
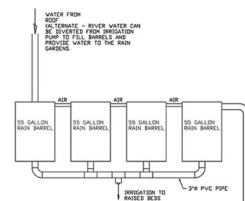
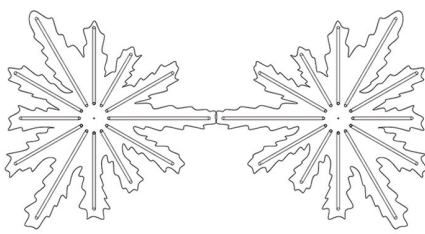

ELEVATED RAIN BARREL COLLECTION

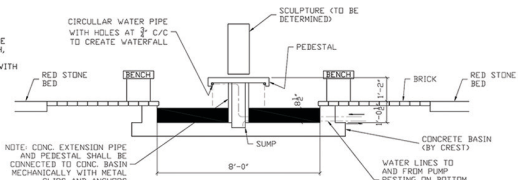
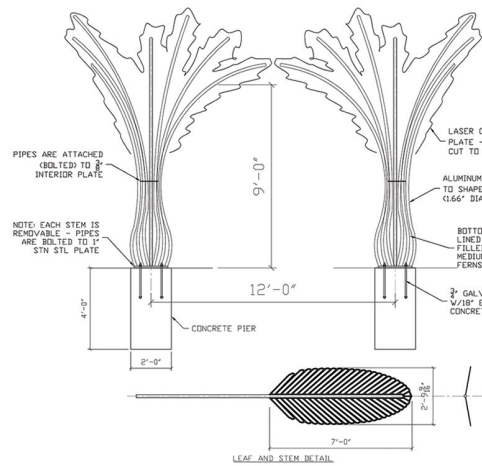

SECTION C-C
CROSS SECTION THROUGH POOL

INTERNATIONAL FRIENDSHIP GARDEN
CAMEROON GARDEN SITE E102

ENTRY - METAL TREE SCULPTURES

NOTE: IN THE EVENT OF AN EXPENDING FLOOD, THESE SCULPTURES CAN BE DISASSEMBLED AND REMOVED TO A SAFE LOCATION

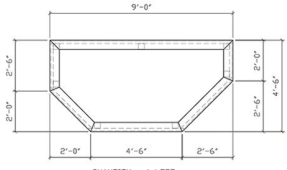

QUANTITY - 1 LEFT

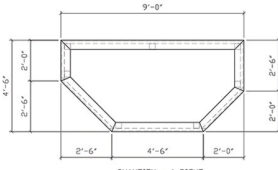

QUANTITY - 1 RIGHT

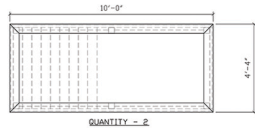

QUANTITY - 2

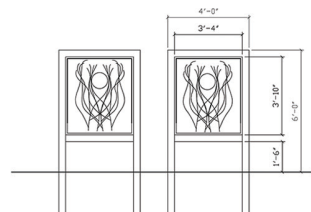

METAL ART PANELS (4)
POSSIBLY LASER CUT ART
PHOTOS, ETC.

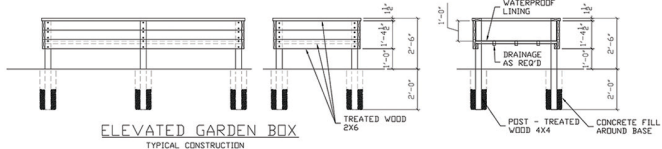

ELEVATED GARDEN BOX
TYPICAL CONSTRUCTION

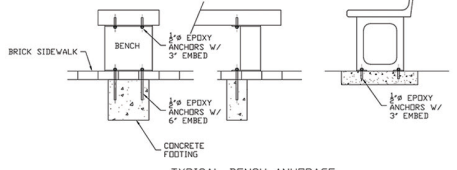

TYPICAL BENCH ANCHORAGE
NOTE: ANCHORAGE MAY VARY ACCORDING TO THE FINAL BENCHES SELECTED OR CUSTOM FABRICATED. ALL BENCHES THAT ARE LOCATED IN A FLOOD PLAIN ARE TO BE ANCHORED TO CONCRETE SLABS OR FOOTINGS. METHODS MAY VARY BASED ON THE BENCH DESIGN AND LOCATION.

INTERNATIONAL FRIENDSHIP GARDEN
CAMEROON GARDEN SITE E103