

Red-tailed Hawk Park Inclusive Playground

AURORA, COLORADO



COMMON GOALS,
EXTRAORDINARY POSSIBILITIES

Together we can address issues that are critical to
our community and make lasting change.



The primary project goals are to:

- » Create side-by-side play between able-bodied kids and those with disabilities
- » Provide play and learning experiences which challenge all abilities and allow growth
- » Use sounds, colors, smells, texture and light to stimulate the senses

Why?

Inclusive playgrounds address the needs of all children, including those who have autism, intellectual disabilities, hearing impairments, cerebral palsy, spina bifida and other challenges. An inclusive playground accommodates all and challenges kids at their own level of development. All kids deserve the chance to get outside and play.

Together we can provide services our community needs

- Over 7,000 kids (preschool to 12th grade) live in the service area of this park.
- 4250+ kids in special education programming attending one of the two school districts in Aurora.
- Providing an inclusive playground with side-by-side play allows families to play and relax together.

**This supports our shared goals of
community service, respect, and compassion.**

You can make an impact!

You, your family, and your business are invited to partner with the Aurora Rotary Club and the City of Aurora to make this vision a reality. Every little bit helps! Permanent recognition at the park and online is offered to donors that reach certain targets. This is a great way to be recognized for your commitment to your community. Thank you for considering this park project, and donations may be made to the Aurora Rotary Foundation, a 501(c)(3) organization, by visiting www.aurorarotary.com.

\$10,000 — 16" Recognition

\$5,000 — 12" Recognition

\$2,500 — 10" Recognition

\$1,000 — 8" Recognition

(Business name within the park in designated locations
Similar in size, type and location as shown)



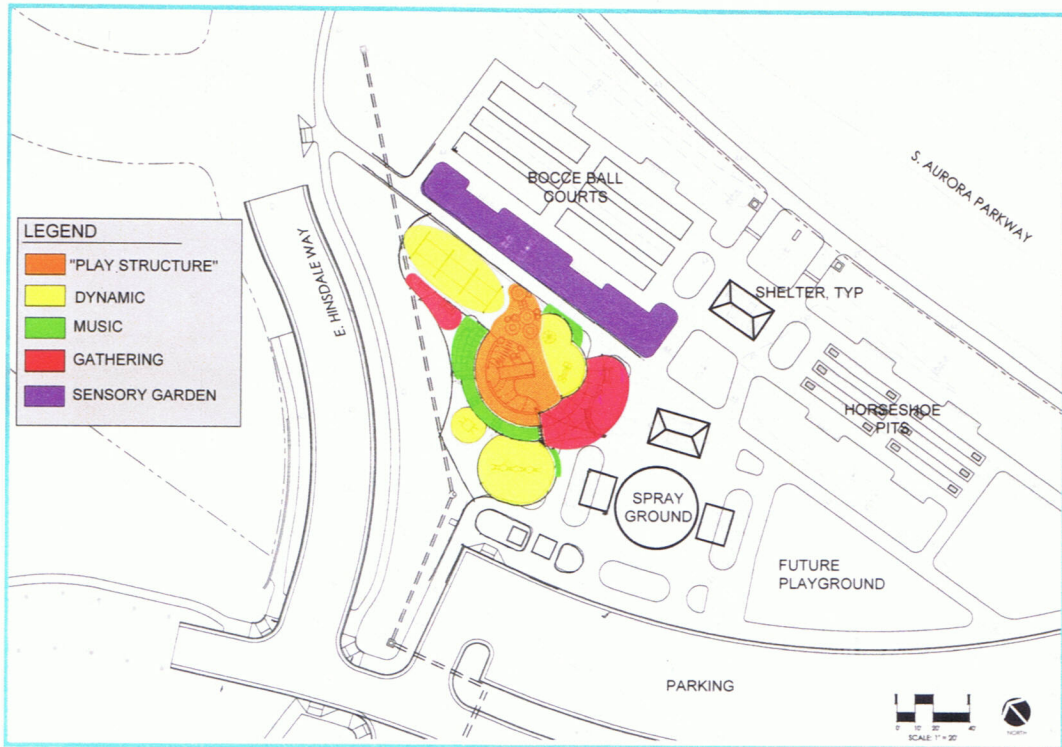

Planned Amenities

- Music and sound
- Dynamic play
- Play structure
- Art feature
- Sensory garden

