

# Baravan Caravans

1954 - 1988

*Introducing a Distinctive Range of All Metal Caravans from the*

**CARAVAN CENTRE OF WA**  
PTY. LTD.



DESIGNED AND MANUFACTURED BY

**Baravan PRODUCTIONS**

129 WELSHPOOL ROAD, WELSHPOOL, W.A. + Phone 68 2835

## BARAVAN CARAVANS

1954 – 1988

### THE EARLY YEARS

The first Baravan Caravan was built in 1954 by David and Horace Barrett at Bridge Street in Riverton. This was the home of Horace and Vi Barrett, father and mother of David Barrett.

Horace being an Aeroplane Mechanic in WW2 and an all-round 'mister fix anything' sort of man actually built a caravan in 1947. No doubt he was the inspiration and means for David to build his first caravan.



Horrie and Vi Barrett with Phyllis and Syd Keirle

David after leaving school at 15 worked in the National Bank in Goomalling with the intention of becoming an accountant. After 3 years he left the bank to work on his uncle's farm in Dukin then to Jerramungup where he had a fencing contract for the War Service Settlement Scheme.

Probably the idea of caravan manufacturing for David came from meetings with his mother Vi whilst she was working for Syd Keirle who had a caravan business. The business was located in Victoria Park, Syd was the agent for Carapark Caravans which were manufactured in NSW (Australia's largest Caravan manufacturer at the time). David used to call in and see his mother from time to time and met Brenda who was the stepdaughter of Syd Keirle. As they say, one thing led to another and David and Brenda married.

Prior to marrying he and a mate 'Kiwi' had been living in tents during the fencing contract however this was not really suitable for a newly married bride so David and his father built a caravan in 6 weeks for their accommodation. The caravan was 18 ft long, ply covered and painted.

A colour band was painted on later.



The first Baravan – 1954 – David and Brenda



The first Baravan with colour band



Horrie's (Horace's) caravan – 1947



Brenda became pregnant that year and they returned to Perth and lived in David's parent's house in Riverton (now Wilson). On returning to Perth the decision was then made to make caravans for a living. Several more caravans were made at Riverton in 1955 before finding a suitable factory in Bentley.

It was a basic shed near Adrian Street that unfortunately flooded so David purchased a property, **129 Welshpool Road, Welshpool**. This was originally a duck farm owned by Mr and Mrs Myer. David's mother, Vi Barrett was the instigator of dealings with the Myer's and developed a friendship with them prior to suggesting selling the property to her son. A shed was built on it to make caravans which became the home of Baravan and the family lived next door in a rented house.



1955 Baravan built at Riverton



Interior 1955 Baravan

In 1956 business was so slow they nearly shut up shop when they couldn't pay any bills. In order to keep going a caravan was sold to Syd Keirle which enable them to pay their bills.

David had worked in the National Bank and looked for employment with the bank, unfortunately there was no married accommodation available so decided to give it one last shot and build some vans for display at the **1956 Perth Royale Show** which was the start of the business picking up again.

Vi Barrett, (Mother of David) told a story to Jenny Barrett (wife of Bruce) that when she was displaying and operating the '**Foldavan**' camper at the Royal Show in 1956 she remembered displaying and erecting it with several interested people when it fell on her head, this was not a good look, however 1 person still bought one. Needless to say there were probably some design issues and that product wasn't seen for long on the market.



Baravan Caravan display 1956 Perth Royal Show



'Foldavan' 1956 Perth Royal Show



1957 Baravan at Welshpool

By the late 50's the business was finally moving ahead however being a manufacturer and retailer of your own product had it's limitations as David found and needed to be either one or the other to grow.

With his father Horrie they built the first part of the factory and as business grew so did extensions to the factory.

The first extension were approved in June 1957, then extensions approved in May 1959, more extension approved in December 1961 and finally extensions in February 1963 to the property purchased next door at 127 Welshpool Road, Welshpool.

Properties at 125, 123 and 121 Welshpool Road were purchased in future years.



1959 Baravans at Welshpool Factory



## EXAMPLES OF DOMESTIC BARAVAN CARAVANS



1960 Baravan at Welshpool



1962 Baravan Interior



Horrie and Vi Barrett bogged on the Nullabor 1962



1960 /1961 Baravan at Welshpool



Feb 1966 Royal 13'9" 2SD.No.886



1960/1961 Baravan at Welshpool



1962 Baravan Caravan



Jan 1969 Regal 21' D2S2S. No. 1580



## BARAVAN DOMESTIC CARAVAN PRODUCTION

During the 1960's **Baravan Productions** were Western Australia's largest Caravan Manufacturer. The alliance formed with Skipper Baileys in Victoria Park as Baravan's sole supplier of Domestic Caravans created an alliance which ensured the ongoing future for Baravan's through the 1960's.



1963 Baravan Caravan's Factory on Welshpool Road

In December 1963 **Skipper Bailey Motor Company Limited** took delivery of their first Baravan Caravan. This was chassis number 449 an 'All Metal Caravan', 13'2" in length and model LD (lounge dinette).

The business arrangement with 'Skiippers' continued until June 1970. Retailing of Baravan Caravans then returned to Welshpool and sold through 'Caravan Centre of WA'.

The sales yard at Welshpool was alongside the Baravan factory and opposite Bitone Caravans.

Size of caravans ranged from 10' to 26' with each caravan being described by size (length) and layout.

Mid 1965 descriptions also included a Model.

For example:  
11'4", Safari, D2S

**INFORMATION BY YEAR OF PRODUCTION DESCRIPTIONS, SIZES AND CHANGES**

Size: 11foot 4 inches long  
Model: Safari Caravan  
Layout: Dinette and 2 single beds

**INFORMATION BY YEAR OF PRODUCTION DESCRIPTIONS, SIZES AND CHANGES**

**1954 – 1960**

Chassis number 0 – 200  
Approximate production number 200  
Exterior: Plywood painted.

**1960**

Production estimate 48  
Chassis numbers 201 – 249  
Exterior: Plywood painted or Flat  
Aluminium sheet.

**1961**

Production estimate 50  
Chassis numbers 250 – 300  
Exterior: Plywood painted or Flat Aluminium sheet  
and 2 – 22' All Metal Caravans.

**1962**

Production estimate 56  
Chassis numbers 301 – 357  
Exterior: Plywood painted or Horizontal hand pressed  
'log cabin patterned' Aluminium sheet.  
All Metal Commercial Caravans 10' – 16' for SEC.  
From Chassis number 351 onward all Domestic  
Caravans produced as All Metal Caravans (steel  
framed and aluminium lo patterned sheeting).  
Release of the 13'2" – models 3S, 2SD, LD, 2SL.  
The largest Baravan produced – the first 26' caravan.



### 1963

Production number 80 caravans  
Chassis numbers 358 – 453  
Exterior: Horizontal hand pressed 'log cabin patterned' Aluminium sheet.  
16' Commercial Caravans  
10' models 2S  
13'2" models LD, 2SD, 3S  
14'6" models LD, 2SD, 2SL  
16'6" models LD, 2SD, 2SL, 4SD  
December 1963 first 2 caravans supplied to Skippers.

### 1964

Production number 213  
Chassis numbers 454 – 665  
Exterior: Horizontal hand pressed 'log cabin patterned' Aluminium sheet and later Horizontal 'rolled single ribbed' silver Aluminium sheet.  
14' Commercial Caravans  
10' models 2S, 2L  
13'2" models LD, 2SD, 3S  
14'6" models LD, 2SD, 2SL  
16'6" models LD, 2SD, 2SL, 4SD

### 1965

Production number 205  
Chassis numbers 666 – 870  
Exterior: Horizontal 'rolled single ribbed' silver Aluminium sheet.  
14' Commercial Caravans 3S, 4S  
13'2" models LD, 2SD, 3S  
14'6" models 2SD, 2SL  
16'6" models 2SD  
From chassis number 700 use of Model names.  
Wayfarer 11'  
Safari 13'2" and 14'6"  
Ranger 14'  
Royal 15'6"

### 1966

Production number 207  
Chassis numbers 871 – 1078  
Exterior: Silver 'RS2' patterned aluminium sheeting.  
Ranger 13'9"  
Safari 11'4", 13'9", 15'2"  
Royal 13'9", 15'2", 15'6"

### 1967

New models from January 1967.  
Production number 255  
Chassis numbers 1079 – 1333  
Exterior: Silver 'RS2' patterned aluminium sheeting.  
Ranger 11'4", 13'9", 15'2"  
Safari 11'4", 13'9", 15'2"  
Royal 13'9", 15'2", 18'6", 20'  
Regal 17', 21' (started in August)

### 1968

Production number 238  
Chassis numbers 1334 – 1576  
Exterior: Silver 'RS2' patterned aluminium sheeting.  
Ranger 13'9", 15'2" x 8' wide  
Safari 11'4", 13'9", 15'2", 15'2" x 8' wide, 16'6"  
Royal 15'2"  
Regal 21'  
Empress 15'9" x 8' wide

### 1969

Production number 227  
Chassis numbers 1577 – 1798  
Exterior: April, start of 'White RS2' pattern aluminium sheeting and 'Baker' windows and doors.  
Exterior: Commercial caravans in silver RS2 Aluminium.  
Ranger 13'9", 15'9" x 8' wide  
Safari 11'4", 13'9", 15'2"  
Royal 15'2"  
Regal 21'  
Empress 15'9" x 8' wide

## 1970

Production number 141  
Chassis numbers 1799 – 1959  
Exterior: 'White RS2' pattern aluminium sheeting then introduction of Vertical White 'log cabin' hand pressed Aluminium sheeting.  
Exterior: Commercial caravans in silver RS2 Aluminium.  
Ranger 14', 15'9", 16'  
Safari 11', 14', 15'  
Royal 14', 15'  
Regal 19', 22', 25'  
Empress 15'9", 16', 19'  
Princess 14', 15'

## 1971

Production number 113  
Chassis numbers 1960 – 2052  
Exterior: Vertical White 'log cabin' hand pressed Aluminium sheeting.  
Regal 19', 22', 25', 26'  
Empress 16', 19' Princess 11', 14', 15'

## 1972

Production number 93  
Chassis numbers 2053 – 2147  
Exterior: Vertical White 'log cabin' hand pressed Aluminium sheeting.  
Regal 22', 26'  
Empress 16', 19'  
Princess 11', 14', 15'  
Safari 13'9"  
New external shape to a 16'  
Model Empress

## 1973

New 15' x 8' Princess in September  
Production number 126  
Exterior: Vertical White 'log cabin' hand pressed Aluminium sheeting.  
April start of wind-out windows.  
Chassis numbers 2148 – 2271  
Regal 22'  
Empress 16', 19'  
Princess 11', 14', 15', 15' x 8' wide

## 1974

Production number 115  
Chassis numbers 2272 – 2393  
Exterior: Vertical White 'log cabin' hand pressed Aluminium sheeting.  
Regal 22', 26'  
Empress 16', 19'  
Princess 11', 14', 15', 15' x 8' wide

## 1975

Production number 82  
Chassis numbers 2394 – 2475  
Exterior: Vertical White 'log cabin' hand pressed Aluminium sheeting.  
Regal 19', 22', 26'  
Princess 15', 15' x 8' wide  
Commercial production thereafter

**Note:** There is a variation in the chassis numbers when compared with actual production. The factory closed over the December – January period for annual leave and some chassis's did not follow numerically when the order was placed. Some vans were placed as a priority and produced forward of some other chassis numbers and so ended up being produced in a different calendar year.

Timber caravan framework was Tasmania Oak timber with radius and curves steam bent. Overlapping horizontal and vertical timbers were half checked overlaps and screwed at the joint.

Early chassis were steel A frames and front and rears and main chassis rails incorporating the use of Karri timber longitudinals. Angles welded across the main rails supported the timber.

In the years of manufacture where Plasply and Flat aluminium sheeting were fitted to the exterior timber framework and special attention to ensure that all slotted screw heads were aligned in the same direction.

Interior paintwork consisted of the application of pink primer, undercoat and then an enamel top coat with the company supplying the paints being 'Spartan Paints'. In later years they also supplied automotive lacquer for the colour bands on the white acrylic coated aluminium sheeted caravans.

Silver Horizontal 'rolled single ribbed' Aluminium sheet prior to RS2 known by staff as RS1 – 1964 to 1965 built caravans.



## ADVERTISING

1958 Keith Winser 'Caravan & Touring Manual'

1960 Keith Winser 'Caravan & Touring Manual'

**West Australian Caravan Specialists**



- **HOME BUILDER KITS**  
Build and save with the aid of OUR PRE-FABRICATED KITS AND FREE ADVISORY SERVICE
- **PARTS and ACCESSORIES**  
Large stocks of all components available at our Spare Parts Division.

• **QUALITY CARAVANS**  
Large range of models, also custom built to your requirements. Commercial Vans a speciality.

**BARAVAN PRODUCTIONS**  
129 WELSHPOOL RD., WELSHPOOL, W.A. — PHC

ASK FOR DETAILS OF THE FOLD-AWAY TRAILER AND CONSTRUCT-A-VAN KITS AND PARTS.



PAGE 17

1961 Keith Winser 'Caravan & Touring Manual'

**Baravan PRODUCTIONS**  
*The CARAVAN CENTRE of W.A.*



★ **Distinctive Caravans**

★ **Home Builder Kits and Shells**

★ **Parts and Accessories**

**BARAVAN PRODUCTIONS**

129 WELSHPOOL RD., WELSHPOOL, WEST AUSTRALIA  
Phone 68 2835

**Baravan PRODUCTIONS**  
*The CARAVAN CENTRE of W.A.*

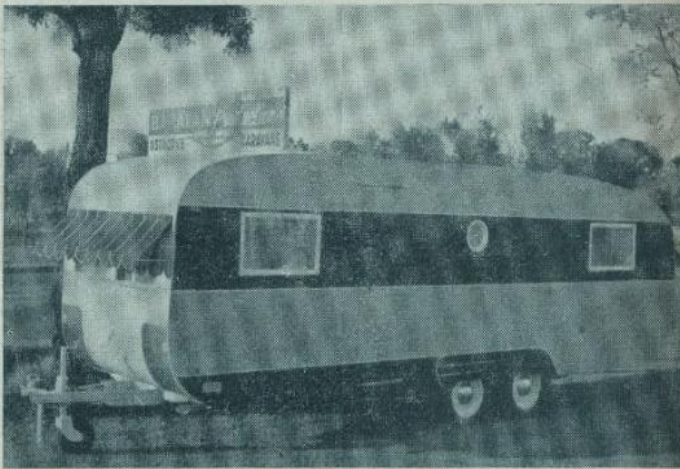

**BARAVAN:** From Welshpool, W.A., comes the Baravan in five different models, ranging from the 11 ft. to the 23 ft. Tandem shown above. Gas cookers are optional. The Tandem is in aluminium, the others in plywood or tempered hardboard. Illustrated below are two interior shots of the 16 ft. Baravan, popular with Holden and Zephyr. Gas stove and fridge are included.



**Baravan PRODUCTIONS**  
*The CARAVAN CENTRE of W.A.*



**ans**  
**s and Shells**  
**ories**  
**VATIONS**  
**L. WEST AUSTRALIA**



**BARAVAN:** From Welshpool, W.A., comes the Baravan in five different models, ranging from the 11 ft. to the 23 ft. Tandem shown above. Gas cookers are optional. The Tandem is in aluminium, the others in plywood or tempered hardboard. Illustrated below are two interior shots of the 16 ft. Baravan.





## Skipper Bailey Brochure 1969

# Baravan

## CARAVANS OF DISTINCTION

Australia's Finest Modern Light Weight All Metal Caravans



*For Wonderful Carefree Holidays  
and superb mobile living*

Choose one of these Luxury Caravans from

THE BEST  
CARAVAN VALUE  
From W.A.'s  
**BIG**  
CARAVAN  
PEOPLE

# SKIPPER BAILEY

MOTOR COMPANY LIMITED

734 ALBANY HIGHWAY EAST VICTORIA PARK. 6101. PHONE 6 2624, 61 9538

CHOOSE A BARAVAN . . . The accepted name for GOOD QUALITY and DEPENDABILITY

## Baravan 'SAFARI'

THE NEW BARAVAN "SAFARI" MODELS 15'2", 13'9" and 11'4"



PERFORMANCE PROVED FOR ROUND AUSTRALIA TRAVEL

The new Baravan "Safari" models 15'2", 13'9" and 11'4" offer the widest choice of interior designs in Australia. Beautifully appointed with spacious interiors tastefully decorated — three to six berths — wide, comfortable beds — generous cupboard space with high-quality practical fittings — large refrigerator and 2-burner and grill stove gas operated. With the comforts of home for luxury living and entertaining on exciting extended tours. Balanced for easy dependable towing over all terrains, making caravanning a real pleasure.

BUILT TO LAST — BACKED BY WRITTEN WARRANTY — SERVICE AND PARTS

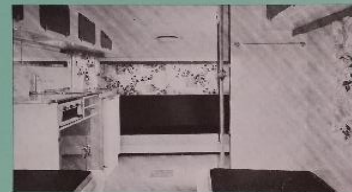

CHOICE OF INTERIOR LAYOUTS ILLUSTRATED ON BACK COVER

### ABRIDGED SPECIFICATIONS

- 2, 3 or 4 Berths, plus optional auxiliaries.
- 6-ply Tyres and Tubes.
- All-steel Chassis and Frame (Heavy Duty).
- Fully Insulated sides and roof.
- Exterior covered, high-quality formed aluminium sheet.
- Large panoramic rubber-sealed wide-opening windows with attractive curtains and pelmets.
- Larger all-weather, tropic roof hatch ventilators.
- Doors, windows and hatch flywired.
- Inlaid lino tiles on floor.
- Spacious wardrobe, cupboards plus abundance of locker space.
- Laminex table and cupboard tops.
- Refrigerator — Choice of 2 cu. ft. or large 3 cu. ft. LP. gas.
- Stove — LP. gas, 2-burner and grill.
- Wiring — to S.E.C. standards for 250 volt AC. or 12 volts.
- Stainless steel sink with water tank and pump.
- Wide, comfortable, easy-to-make beds with super foam mattresses vynox covered.
- Choice of layouts and attractive colour trim combinations.

**HOLIDAYS**

HAPPY AND CARE-FREE WITH  
THE COMFORTS OF HOME

**GO BUY Baravan**

Baravan 'SAFARI' Models  
11'4" from \$  
13'9" from \$  
15'2" from \$

## Baravan 'ROYAL'

THE NEW BARAVAN "ROYAL" MODELS 15'2" and 13'9"



PERFORMANCE PROVED FOR ROUND AUSTRALIA TRAVEL

The outstanding new Baravan "Royal" models 15'2" and 13'9" combine luxury, elegance and style with a host of new features — large panoramic windows — two to six berths with wide beds and luxurious furnishing — loads of cupboard and wardrobe space with woodgrain panelling — large gas/electric refrigerator and a choice of two burner stove with grill or stove with oven.

Balanced for perfect towing and manoeuvrability. Specially designed for Wonderful Carefree Holidays with the convenience of home. Another classic example of Baravan craftsmanship.

BUILT TO LAST — BACKED BY WRITTEN WARRANTY — SERVICE AND PARTS



CHOICE OF INTERIOR LAYOUTS ILLUSTRATED ON BACK COVER

### ABRIDGED SPECIFICATIONS

- 2, 3 or 4 Berths, plus optional auxiliaries.
- 6-ply tyres and tubes.
- All Steel Chassis and Frame, heavy duty.
- Fully insulated sides and roof.
- Exterior covered high quality formed aluminium sheet.
- Large wide opening Panoramic rubber sealed windows with attractive curtains and pelmets.
- Larger all weather tropic roof hatch ventilators.
- Doors, windows and hatch fully flywired.
- Spacious wardrobe and cupboards. Polyester wood-grain finish.
- Refrigerator — Large 3 cu. ft. combination LP gas/Elect.
- Stove — Choice of LP gas stove and grill or stove and oven combinations.
- Kitchen unit — Stainless steel sink 36" x 18" with water tank and pump.
- Mattresses — Highest quality luxurious 5" foam covered with Tuffmaster deerhide.
- Floor — Covered with easy to clean vinyl plastic tiles.
- Wiring — To S.E.C. standards for 250 volts AC or 12 volts.
- Choice of layouts and attractive colour trim combinations.
- De Luxe Lights and Fittings to conform with traffic regulations.

THE BEST  
CARAVAN VALUE  
From W.A.'s  
**BIG**  
CARAVAN  
PEOPLE

For the largest and most comprehensive range  
of new and used caravans in W.A. . . .

# SKIPPER BAILEY

734 ALBANY HIGHWAY, VICTORIA PARK

MOTOR CO.  
LIMITED

Baravan 'ROYAL' Models  
13'9" from \$  
15'2" from \$



## HOME BUILDER KITS

A large part of Baravans business was producing Caravan Shells or Chassis's with Steel Framework being bought by those wanting to build and fit out their own caravan.

The customer was then able to save on the labour costs in buying a completed caravan but still having technical advice and shown how to go about the process by Baravan's.

All of parts, components and knowhow was at their disposal to draw on from Baravan's experienced staff to build a quality and robust caravan.

Records from chassis number 200 (year 1959) - 453 (December 1963) show a variety of home builder products described as:

- Ali Kit
- Ali Shell
- Bond Shell
- Plasply Shell
- Ply Shell

During this period around 60 were sold to Home Builders wanting to make their own caravans.

One such 'Home Builder' is 95 year old Mr. Bill Kennedy who bought a 13'2" 'Baravan Shell', chassis number 392 which came out of the factory 29.03.1963.

The quality of Bill's workmanship was excellent and the caravan remains in the family having celebrated it's 50<sup>th</sup> year in 2013 doing 210 trips and travelled 188,759 kilometres (Bill kept records of everything).



2017 - Bill Kennedy with his Baravan

The 2nd last home builder kit sold was chassis number 2403, a 15 x 8 shell delivered out of factory 24.02.1975, the last being 14 x 7, chassis number 2483 delivered out of factory 20.03.1976

## COMMERCIAL CARAVANS

Many were built by Baravan, the first four being built for the Forestry Department in October 1960.

Early Commercial Caravan customers also included:

- Church of England - 1960
- Western Mining - 1962
- State Energy Commission - 1962
- Geophysical Survey - 1963
- P.M.G. - 1963
- Co-operative Bulk Handling - 1963



Above was built for a WA farmer for Domestic use chassis 261, 22' All Metal Commercial 1960/1961.



After **Skipper Baileys** became the Baravan's distributor there were a considerable number of 'Commercial - Work Vans' built and sold in 1964-65. This was due to the expanding Mining Industry and the addition of the Standard Gauge Railway being built across the Nullabor to join WA with the other states.

112 Commercial Caravans were built and sold in this period:

July - August 1964 - 30 caravans  
 December 1964 - 36 caravans  
 (note: 2 built per day)  
 March 1965 - 12 caravans  
 July 1965 - 3 caravans  
 August 1965 - 13 caravans  
 November 1965 - 18 caravan



Above most likely to be Nos. 252, 253, 254, 255 built for Church of England Nov 1960



Blessing of caravans above in 1961 St Georges Terrace



April 1971 16' Commercial . No. 1957



Commercial Caravans W.A.G.R. Est. 1978

Commercial Caravan Manufacture continued with Government Departments and Mining Companies, Co-operative Bulk Handling etc until around 1983.

Traditionally Commercial Caravans were built using 1" square tubing for the framework whereas the domestic caravans used ¾" steel tubing. Shape was very square and no colour bands were painted unless specified as in the case of W.A.G.R. who required a blue colour band painted on all of their caravans.

Quality Commercial Caravans were well sought after especially with the good name of Baravan.

In 1979/80 Baravan won a contract for the production of 47 caravans for the Main Roads Department.

This proved to be a great contract which Bruce and his wife Jenny managed from quotation to completion.

Bob Butcher was contracted (formerly of Blue Bird Caravans) to build and deliver the chassis's and Bruce's brother Brian to build and delivery the furniture.

The manufacturing process was slightly different from the traditional Baravan with the side frames made using a combination of steel channel and steel tube and then welded to the chassis (traditional Baravan Caravans used 19mm square tubular steel sides, fronts and rears with pressed steel channels to form the roof).

It proved to be an efficient way to build however the decline in commercial caravans was bought about in part by reduced expenditure by Government Departments and the use of relocatable structures such as Donga's and Transportable and Manufactured Buildings for purposes previously set aside for caravans.

The front and rear were of the same construction however were bolted and screwed to the chassis and side frames and the roof was made of steel welded then dropped on top of the side frames and bolted and screwed together. This was a similar method used by eastern states manufactures using aluminium for the framework.

**14' First Aid Caravan Est. 1982**



**18' Single Axle Lands & Surveys Dept.  
Est. 1978**

**22' Accommodation Caravan Est. 1982**





## CARAVAN SPARE PARTS

The spare parts business evolved around offering parts and components for the 'Home Builder' – Caravan Shells (completed exterior ready for internal fitout), chassis with framework plus all of the necessary parts to complete the build for the home handyman.

The longer the business continued replacement parts sales for existing caravans increased parts sales for the business. With retail sales of Baravan Caravans also came the need to provide accessories for their customers, growing as sale increased.

In 1978 Baravan were the state distributor for Viscount Caravans and also Millard when taken over by Viscount several years later. Along with this was the opportunity to supply parts for these brands and also the good relationship with Viscount opened doors to many of their suppliers so Baravan were able to deal direct with manufacturers of Eastern States parts suppliers to offer a much larger range at very good pricing.

The parts business continued to expand with Baravan under the names of 'Baravan of Welshpool' and 'Caravan Parts of WA' becoming the largest single supplier of Caravan Parts and Accessories in W.A. in the early 1980's.



## Baravan Spare Parts 'Showroom' 1969

By 1984 Baravan had further developed the parts business to encroach on the area previously use for manufacturing at Welshpool into a very successful 'Wholesale/Retail business' supplying most caravan retailers with not only replacement parts and components but also a large range of accessories.

Quoted on our price list – 'If Baravan's haven't got, it's probably not available in W.A.'.

**ADVERT 1984**



## ADVERT 1983

With declining caravan sale around 1988 David reassessed the income from the caravan business verses tenanted property and a decision was made to redevelop the original factory area into showroom warehouse. Part of this plan was the sale of 'Caravan Parts of WA' which would also create a tenant. The parts business was sold to Fleetwood who then moved all of their parts operations to Welshpool.



## CEASATION OF DOMESTIC CARAVAN MANUFACTURING

In the mid 1970's the Baravan Caravans were not as price competitive with many of the Eastern States brands of caravans being sold in Perth. David made the decision to stop producing Domestic Caravans and started importing a N.S.W. brand, York Caravans. York was made in the same factory as Millard and Starcraft.

A 15' x 8' wide Baravan was retailing for round \$3500 while a 15' x 7' wide York model was retailing for around \$2500.

Other manufacturer's representatives were selling brands in Perth such as Millard and Viscount from NSW, Chesney from QLD and many of the Victorian manufacturers at very competitive prices.

The York brand was sold between 1975 - 1977 by Baravan's. Changes were initiated by Fleetwood dropping the Viscount brand in favour of Millard.

Fleetwood were the largest retailer of caravans in W.A. with a Dealer Network including a Wholesale/Retail spare parts and accessories business so for Millard it was their choice to go with the largest retailer to increase their sales.

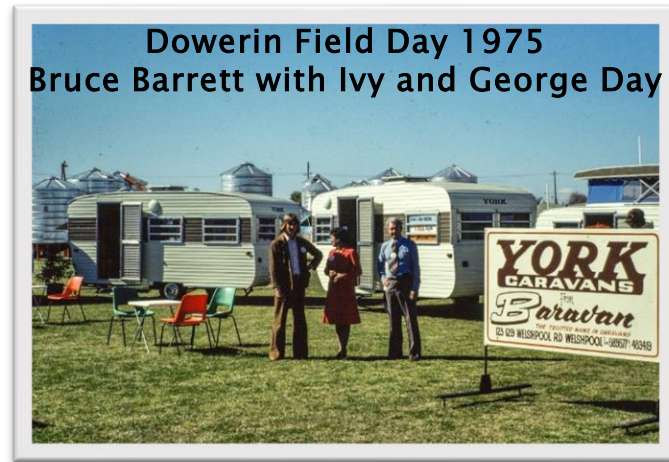

With Caravan and Camping News, September 1978

### ADVERT 1978

## Baravan

THE TRUSTED NAME IN CARAVANS FOR TWENTY FIVE YEARS

#### Baravan-Viscount THE NEW TEAM

Baravan-Viscount is now a part of the Fleetwood Group, the largest caravan and camping retailer in Australia. This new team brings together the expertise of Baravan and Viscount to provide you with the best service and value for money.

**NEW CARAVANS**  
THE EXCITING NEW 1978 VISCOUNT RANGE  
Viscount Explorer Pop-up from 1975  
Viscount Superline from 1975  
Viscount Pioneer from 1975

**FINANCE**  
Complete finance facilities  
Small payments  
No cash down  
Easy arrangements

**SERVICE**  
Baravan-Viscount has the best in the industry with 100 trained staff members. Expert advice and service for all your caravan needs.

**PARTS**  
The most comprehensive range of spare parts and accessories in the industry.

**TOWING AIDS**  
Specialists for all types of towing vehicles.

**REPAIRS**  
Expert repairs to all types of caravans.

**ACCESSORIES**  
All the latest accessories for your caravan.

**INFORMATION CENTRE**  
Visit our information centre for all the latest news and advice.

**SPARES**  
A complete range of spare parts and accessories.

**Baravan-Viscount**  
West Australian Distributors for Viscount  
123-129 WELSHPOOL RD, WELSHPOOL. PHONE 4589677 A/H 4463419

## BARAVAN - VISCOUNT

In 1978 Baravan were appointed Western Australian distributors for Viscount Caravans operating at 123 - 129 Welshpool Road, Welshpool.

ADVERT 1978  
With Caravan and Camping News, September 1978

## Baravan-Viscount

THE CARAVAN LEADERS

### INTRODUCING THE LATEST SERIES VISCOUNT

**MORE MODELS**  
The Explorer Pop-up range has been expanded to include the Explorer Superline and Explorer Pioneer models.

**MORE FEATURES**  
The Explorer Pop-up range has been expanded to include the Explorer Superline and Explorer Pioneer models.

**NEW DECOR**  
The Explorer Pop-up range has been expanded to include the Explorer Superline and Explorer Pioneer models.

**NEW LAYOUTS**  
The Explorer Pop-up range has been expanded to include the Explorer Superline and Explorer Pioneer models.

**LOWER PRICES**

Model	Price
Explorer Pop-up	\$3,290
Explorer Superline	\$4,990
Explorer Pioneer	\$4,990
Explorer Superline (1978)	\$4,990
Explorer Pioneer (1978)	\$4,990

**Baravan-Viscount**  
123-129 WELSHPOOL RD, WELSHPOOL  
PHONE 4589677 A/H 4463419  
Appointed Western Australian distributors for Viscount



Not long after taking on the Viscount brand George Day (George Day Caravans, Cannington) and Peter Cameron (Cameron Caravans, Albany) were appointed as the first **Baravan - Viscount** dealers closely followed by another 9 Dealers making a total Dealer Network of 12 outlets from Esperance to Port Hedland.

The Dealerships operated under the banner of '**Baravan Viscount**' as a '**5 Star Baravan Dealer**'. Sales blossomed and in the early 1980's over 500 new Viscount, Coleman and Millard Caravans in one year were transported to WA.

**Viscount — W.A.'s Big Caravan People**

**Port Hedland**  
HEDLAND CARAVAN & CAMPING CENTRE  
1432 Mirky St, Port Hedland. 6721  
Telephone (081) 73 2066

**Geraldton**  
GERALTON CARAVAN & CAMPING  
180 Chapman Rd, Geraldton. 6750  
Telephone (099) 21 2022

**Rockingham**  
ATKINSON CARAVAN & CAMPING  
6 Patterson Rd, Rockingham. 6108  
Telephone (095) 27 1390

**Mandurah**  
MANDURAH CARAVANS  
47 Pinjarra Rd, Mandurah. 6210  
Telephone (095) 35 7033

**Bunbury**  
PAUL'S CARAVAN CENTRE  
Blair St, Bunbury. 6230  
Telephone (097) 21 5566

**Busselton**  
BUSSELTON CARAVAN & CAMPING  
3 Causeway Rd, Busselton. 6280  
Telephone (097) 52 1051

**Perth**  
GEORGE DAY CARAVAN CENTRE  
1521 Albany Hwy, Cannington. 6107  
Telephone (08) 481 2884

**Albany**  
CAMERON CARAVANS  
559 Albany Hwy, Albany. 6330  
Telephone (085) 41 4674

**Kalgoorlie**  
KALGOORLIE CARAVAN & CAMPING  
Boulder Rd, Kalgoorlie. 6430  
Telephone (086) 21 4366

**Merredin**  
MERREDIN OUTDOOR CENTRE  
2 Mary St, Merredin. 6415  
Telephone (080) 41 1204

**Western Australia**

**Viscount** **Aerolite** **Millard** **Coleman** **Baravan**

**AUSTRALIA WIDE SERVICE GUARANTEED**

Distributed in Western Australia by **BARAVAN CARAVANS WELSHPOOL**

131 Welshpool Road, Welshpool. Tel: (09) 438 9333

ADVERT 1984

**WONDERFUL WORLD OF VISCOUNT**  
**Presents**

**Viscount**  
Pop-ups & Caravans

**AeroLite**  
Pop-ups

**Coleman**  
Camper Trailers

**MILLARD**  
Pop-ups & Caravans

**Baravan**  
Residential

**Join the Great Outdoor Adventure for Enjoyable & Affordable Holiday Packages**

ADVERT 1984

The original owner of Viscount, John Carr sold his business around 1985/86. Unfortunately under the new ownership the business eventually ceased around 1991.

Baravan had already relinquished their ties with Viscount seeing a decline in caravan sales and had redeveloped all of the production and sales yard properties at Welshpool by 1990 into Showroom/Warehouses.



## 10ft. RESIDENTIAL CARAVANS

Around 1980 there was a change in the acceptance of the type of caravans suitable as use for permanent living in Australia. Caravans up to 36 ft long set up with annexes were used for people who chose the lifestyle offered when living in a caravan park. Acceptance was established for the use of semi movable caravans (not required to be licenced) to be used as permanent residence in caravan parks – the evolution of the 10 ft wide on-site caravan.

**Baravan** with their involvement with **Viscount Caravans** were initially transporting 10ft wide Onsite Caravans from Sydney to Perth. This proved to be a problem with travelling restrictions to daylight hours, permits required through some states and the wear and tear on the trucks transporting them. Costs were high and it limited the transport of traditional caravans to Perth.

With the decline in orders for Commercial Caravans in 1983, Baravan changed direction and manufactured the 10 ft wide units at the Welshpool factory. Baravan's first 10ft wide was an 18 ft, 6 berth model designed for caravan parks and then to a more traditional 28 ft x 10 ft model similar to those being produced in NSW.



Production of Baravan's under Viscount name



Viscount Caravans in NSW were happy for Baravan to go their own way with this product and offered assistance originally manufacturing in Perth under the Viscount and Millard brands as this helped to promote their products.

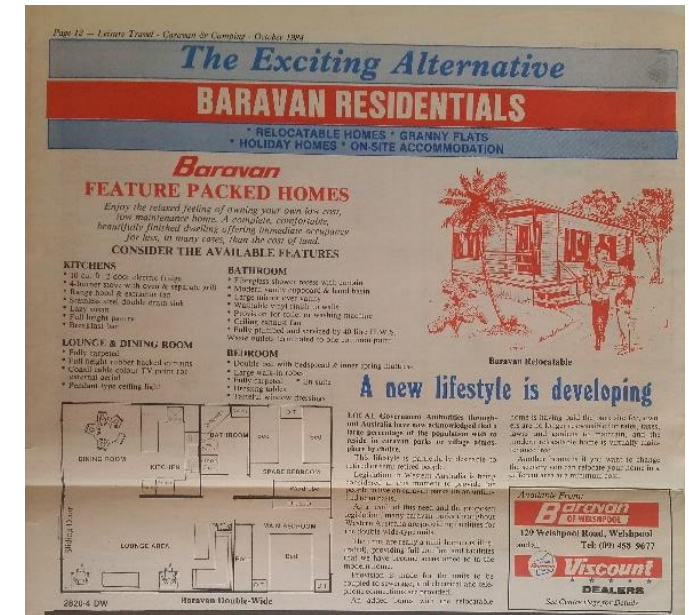

These were distributed through the 'Baravan Viscount' network of Dealers in WA.

The Caravans were built either as a single wide, additional floor and annex or as double wide up to 35' long x 20' wide

Changes in the acceptance of these caravans eventually led to caravan parks being able to buy and locate manufactured housing as on-site accommodation and eventually the decline of the 10 ft wide caravan.



## THE LAST BARAVAN

I retired a few years ago and whilst caravanning with my wife during 2019 in the south-west we discussed what we should do with our current caravan to last us another 10 years.

We thought it would be a great to own one of our family's Baravan's however none were built with ensuites and to convert an older caravan with all the features currently available in 2020 would be a huge task.

Problem solved, I reregistered the Baravan Caravan name and decided to build the last Baravan from scratch having started in October 2019.

Shape is based on a 1969 Baravan, and all steel construction

Size: 20ft x 8ft Body Tare: 2800 kg  
2013 Landcruiser Wheels 18 x 8  
Electric Brakes, Rocker Roller springs

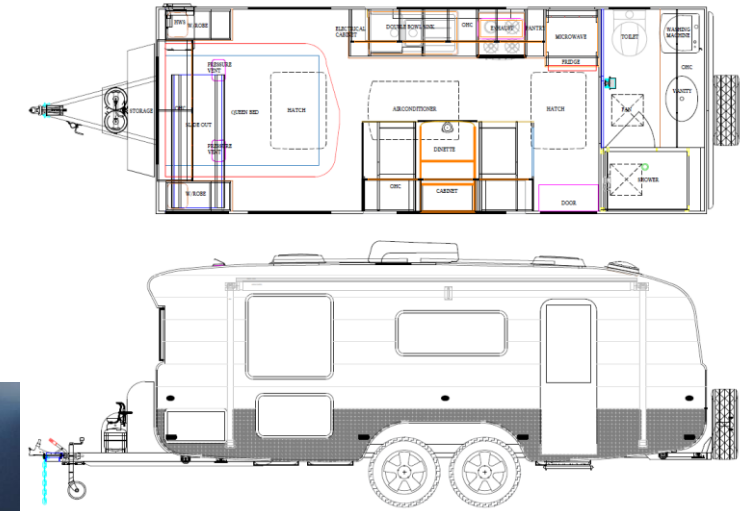

Most of the work was carried out by myself however I was most grateful for some help from family: Jenny, Danielle, Adam and very good friends Austin and Jim. Thanks to neighbouring tenant's for a lift when I need it.  
LPG and electrical work carried out by licenced persons.



The caravan was built in a 6 mtr x 8 mtr unit in Myaree and took around 14 months to complete.

