



Lake Mills Area
SCHOOL DISTRICT

Facilities Referendum 2024

After 14 months of community feedback, the Lake Mills Area School District Board of Education voted unanimously to present residents with two questions to address our highest-priority facility needs.

Question #1

District-wide Facility Improvements

\$36.9M - NO TAX INCREASE*

above the current tax rate for debt

- Address high-priority safety, security, site, and capital maintenance needs at all schools
- Reconfigure outdated learning spaces and special education areas at high school
- Renovate space for Science, Technology, Engineering & Math (STEM) programming, site safety, and health services at middle school
- Provide classroom space for early learning programming at the elementary school

Question #2

Lower HS Gym Replacement/Expansion

\$14.3M - Maximum \$2/YR TAX INCREASE*

for every \$100,000 of property value

- Replace small lower-level gym at the high school with a new, larger gym for school and community use



The District is paying off past debt which allows the District to incur new debt with minimal impact to your tax rate.

Understanding the Cost

Maximum Referendum Tax Impact

Due to current lower interest rates, the tax impact could be lower.

Property Value	Question #1	Question #2
	\$36.9 million NO TAX INCREASE* above the current tax rate	\$14.3 million \$0.02 per \$1,000 of property value starting 11 Dec. 2024
\$100,000	\$0	\$2
\$200,000	\$0	\$4
\$300,000	\$0	\$6

Referend estimate provided by Robert W. Boyd & Co. are planning estimates only. Visit our website for more detail about the financing plan and assumptions.

Tax Rate Impact Compared to Previous Years

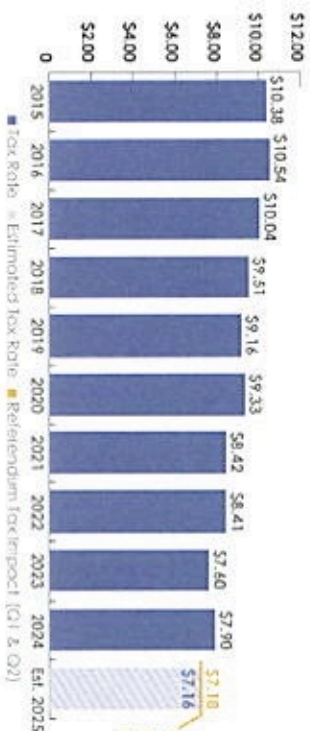

Source: Department of Public Instruction. Note: Significant changes in market conditions, outdated property value, state aid or other factors can result in property tax changes.



Thank you, community!
Your input helped create this solution.

42 community members

participated in 14-month Collaborative Advisory Team (meetings/hours/presentations/prioritization/discussion/feedback)



25% of community shared feedback

through community facilities survey (review/feedback/direction)



60% of residents

support pursuing a referendum according to the community survey



Scan the QR code to visit our website

Project Details - Preliminary and Conceptual Site Plans

Question #1

District-wide Facility Improvements \$36.9M - NO TAX INCREASE* above the current tax rate for debt

Elementary School

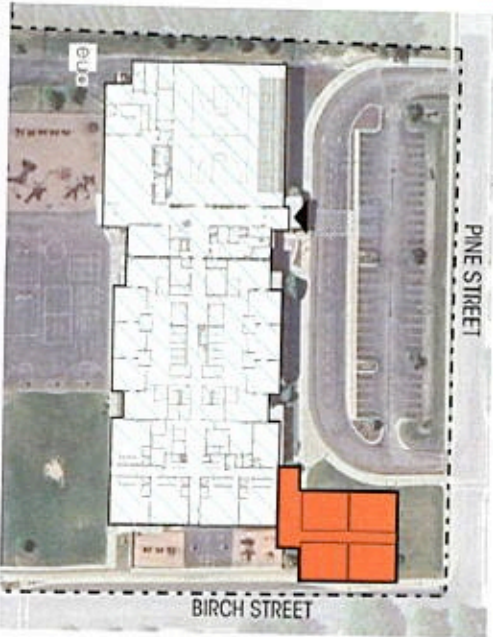

Middle School

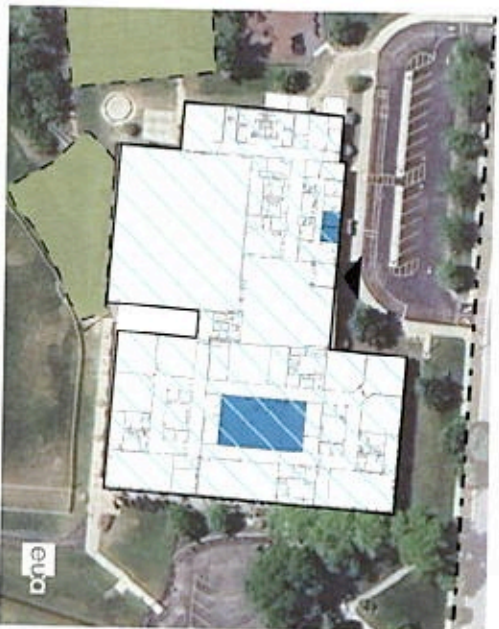

High School

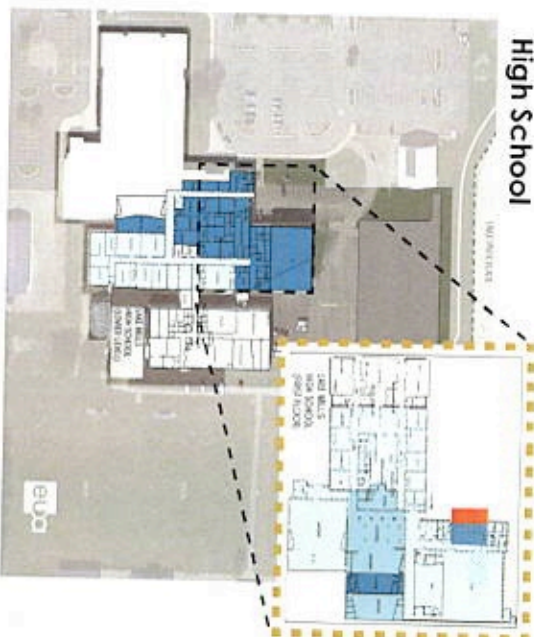

Question #2

Lower HS Gym Replacement/Expansion \$14.3M - Maximum \$2/YR TAX INCREASE* for every \$100,000 of property value

High School

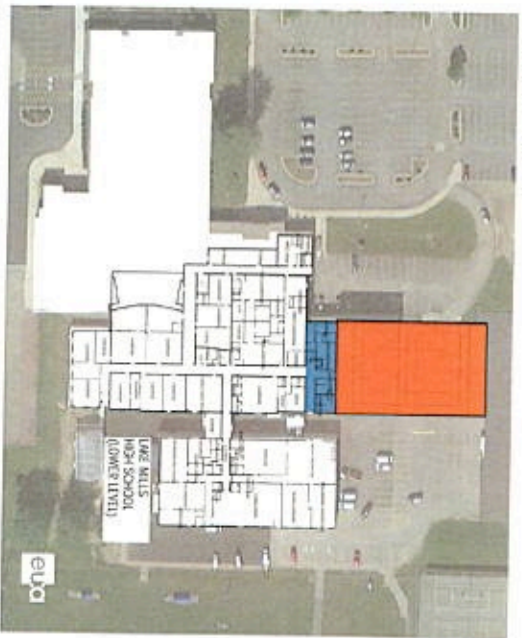

KEY

- Capital Maintenance
- Light Renovation
- Heavy Renovation
- New Construction

* The District is paying off past debt which allows the District to incur new debt with minimal impact to your tax rate.

Contact

District Administrator Tonya Olson
tonya.olson@lakemills.k12.wi.us or 920.648.2215

