



Wellington



**HOSPITALS
FOUNDATION**

Who is in Wellington Regional Children's Hospital Region?

As a Tertiary Hospital, Wellington Regional Children's Hospital provides specialist tertiary care for babies and young patients from

Hawkes Bay / Taranaki
to Nelson / Marlborough.

A demographic with a
population of about 900,000.

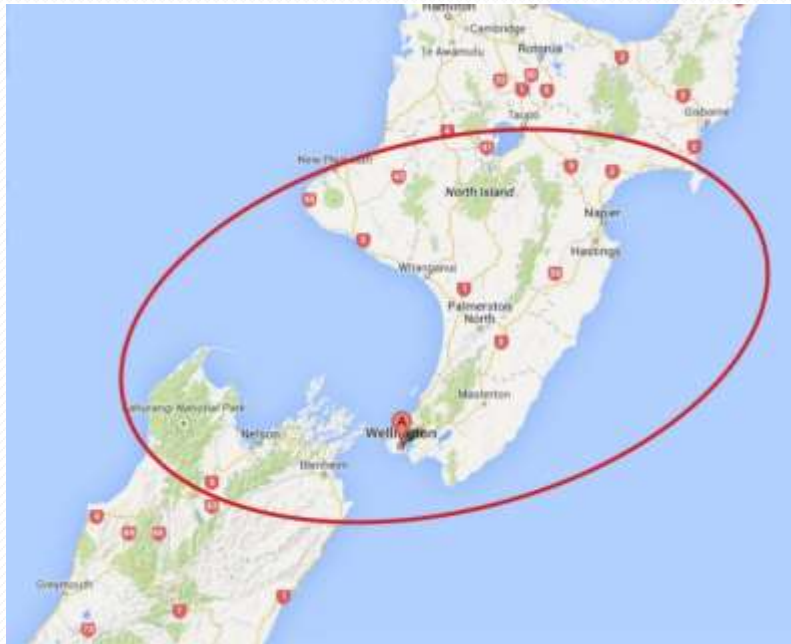



Rotary District 9440

- Same area as Rotary District 9940
- 54 Rotary Clubs, 2 Rotaract Clubs & 3 Interact clubs.



A Suggestion

Idea of New Children's Hospital was suggested by the Foundation to Mark Dunajtschik 16 September 2016





Mark Dunajtschik & Dorothy Spotwood

Announced on the **10th July 2017** that Mr Mark Dunajtschik would build and donate a new stand alone Children's Hospital.

A stunning legacy.....

“My philosophy is people that are born with a healthy body and mind can look after themselves and those unfortunate to be born with, or suffering ill health need our help.”

Mark Dunajtschik



Architectural Designs



Financial Breakdown - \$105 million

- **\$50 million** - commitment by **Mr Mark Dunajtschik** to build and donate a new Wellington Regional Children's Hospital.
- **\$28 million Govt and CCDHB contribution**
- **\$21 million - Government** funding to enable the **demolition** to assist with all site testing and preparation, drainage and demolition of three buildings to make way for the new 7,500m², 3 story, stand-alone Children's Hospital.
- **\$6 million - Wellington Hospitals Foundation and community** for the latest equipment and fit-out to ensure the new Children's Hospital will not only be the best structurally built hospital but the best equipped hospital in the Southern Hemisphere.

What is funding required for?

Medical Equipment

Technology

Furnishings

**Environment
(interior & exterior)**



Mark is funding the building to completion stage. The Foundation will be seeking up to \$6million to complete to project.

Our goal is to have everything as “All Brand New”











TIME FRAME

- Suggestion by Foundation 14 September 2016
- Announcement was 10 July 2017
- Building Site was been identified
- Plans are 90% finalised
- Build started early 2019
- Hospital will be a separate building
- Opening March 2021
- The excitement is building!!



“All Brand New”

Mark is funding the building to completion stage. A
“Spec House”

The Foundation, with the support of the
community, will be seeking community support
to complete to project.

**Our goal is to have everything as
“All Brand New”**



Number of children cared for....

Over the past 12 months there were:

- 6,845 sick children admitted to the Wards
- 34,478 visits to "Paediatric Outpatients"
- 10,607 visits to the Emergency Department
- 3,518 babies born
- 785 neonatal babies (from the region)
- 11,610 x-rays of young people
- 7,000 Paediatric Orthopaedic patients
- 1,326 children seen by the Child Development Service
- 2,343 audiology visits
- 1,817 operations performed on sick children
- 3,198 visits to the Eye Clinic
- 1,588 cardiology patients

Regional Model of Care

***“Localise where possible,
centralise where
necessary”***



It must be a Hospital that is:

- Welcoming for children and their families
- Captures the imagination of younger and adolescent patients
- Creates a sense of comfort and security, supports treatment and healing.
- Is functional and age-adaptive
- Allow patients to create personal spaces, explore, learn and play.
- Encourages family involvement
- Knows that sick kids need escape, too,

Funding of non-medical items will include:

- Technology based initiatives
- Outdoor raised 'Playscape'
- Dedicated social / play areas
- Theming of various areas
- Skywalk link to the main hospital
- Dedicated family / whanau areas
- Holistic 'green' healing areas
- Balconies on each level

Other:

- Site identified and initial demolition work completed.
- Plans finalised
- 24 months to build
- 7500 square metres, over three floors.
- 60 inpatient hospital beds,
- All patient rooms to have own ensuite.
- Pull down beds for parents.
- Outpatient consultation rooms.
- An education and research centre
- Staff and administration areas
- Patient and family friendly areas





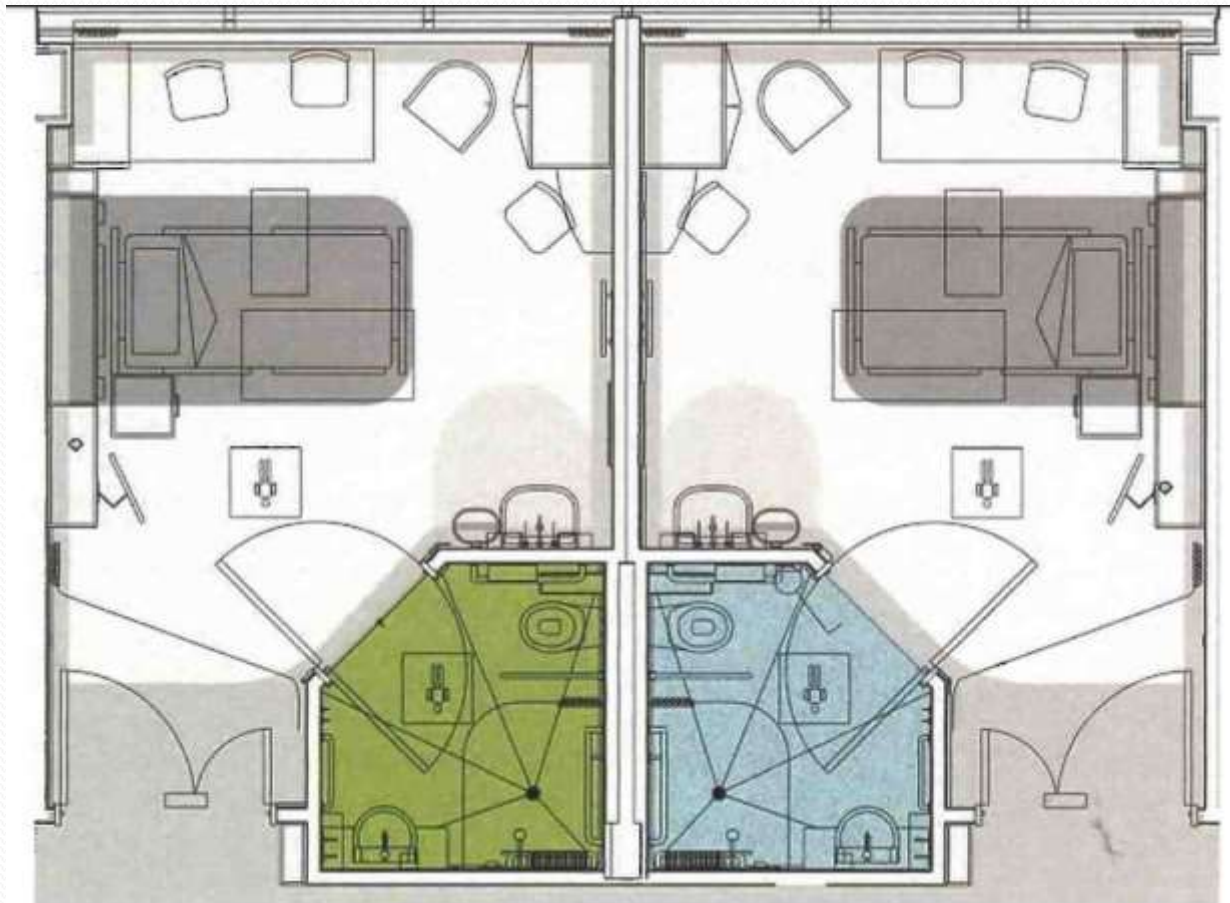



PLAYSCAPE

Playground	Landscape
------------	-----------

PLAYSCAPE

- The new hospitals '**Playscape**' area will be more than a traditional playground.
- It will be an holistic 'green' healing area where young patients of all ages will be able to enjoy the outdoors.
- Patient ages range from birth to 16 years and the '**Playscape**' has been designed with this in mind, with not only play areas, but quiet reflective areas for older patients to sit with friends and families.

Playscape – Conceptual Design



Values & Qualities

Homely
 Social **Whanau/Family**
 Challenging
Safe and Secure
 Stimulation
Fun
Inclusive
 Calming
 Therapeutic/Rehabilitation
 Diverse
All ages
 Refuge **Nature**
 Engaging
 Touch & Feel
 Sanctuary

Theme - Rongoa/Medicinal Plants

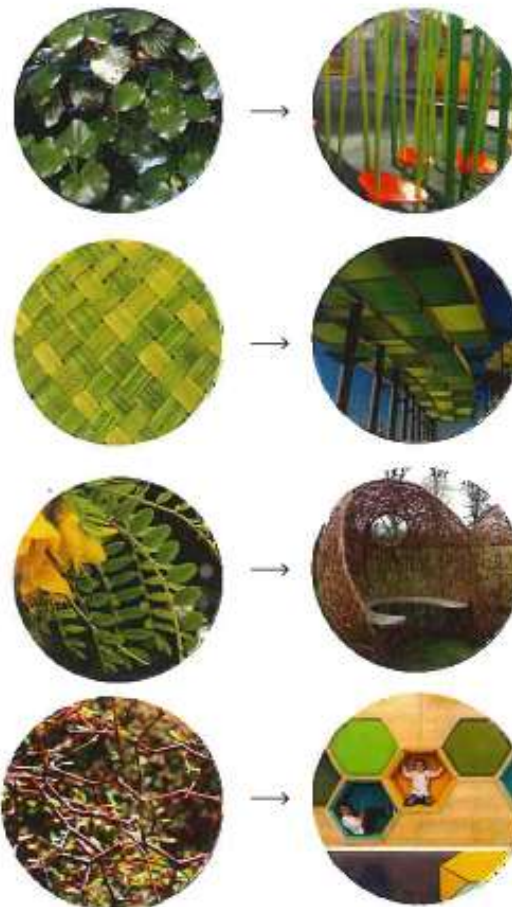

local

Project:
 RT03
 Date:
 3rd May 2019
 Tenders:
 C
 Event for:
 Concept Design Workshop

Project:
 Wellington Children's Hospital
 Bringing the
 Values & Theme

RT03 - P1

.....creative lighting technologies

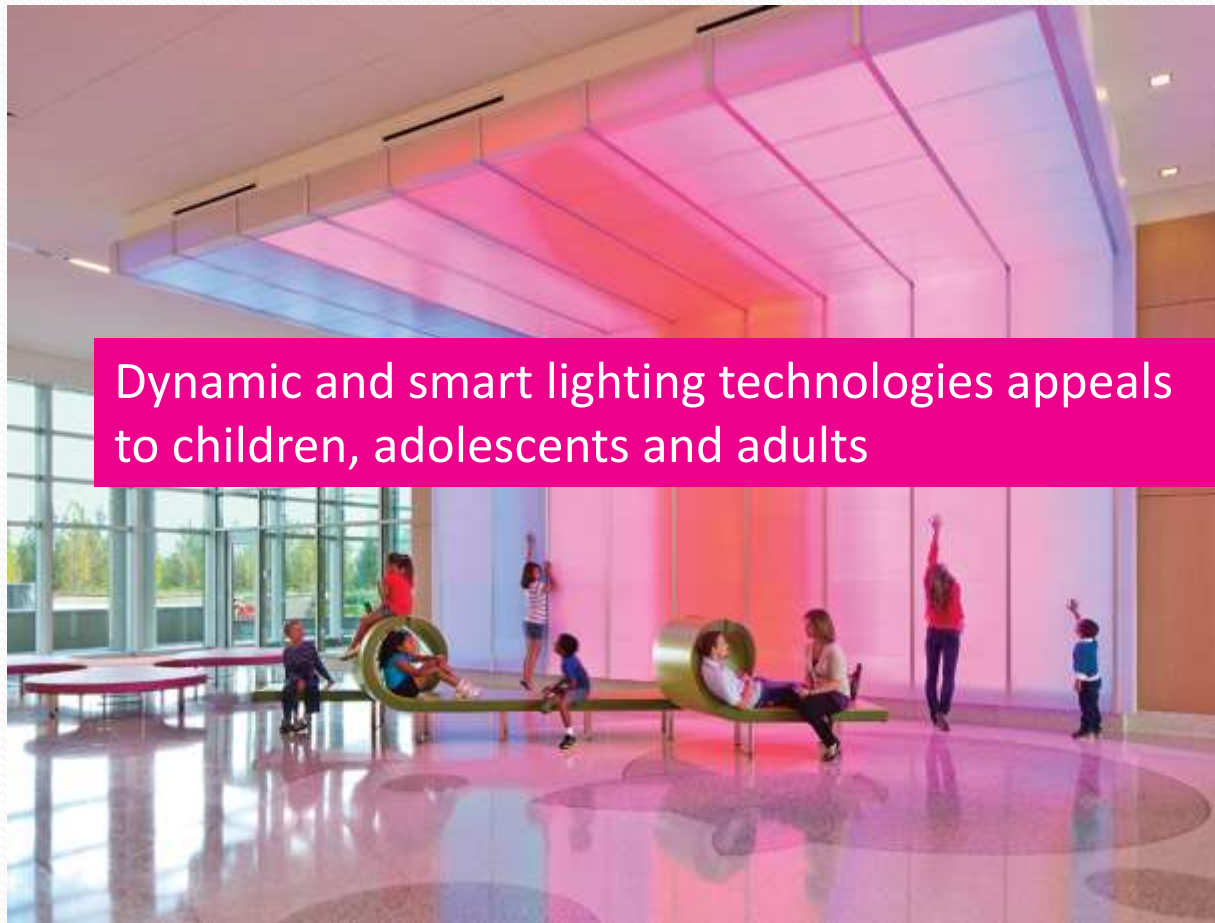

..... creative interactive technologies



Use of digital technology and smart lighting to create interactive, creative, and intellectually stimulating experiences. Virtual Aquariums filled with sea creatures drawn by visitors themselves

.....creative rehabilitation technologies

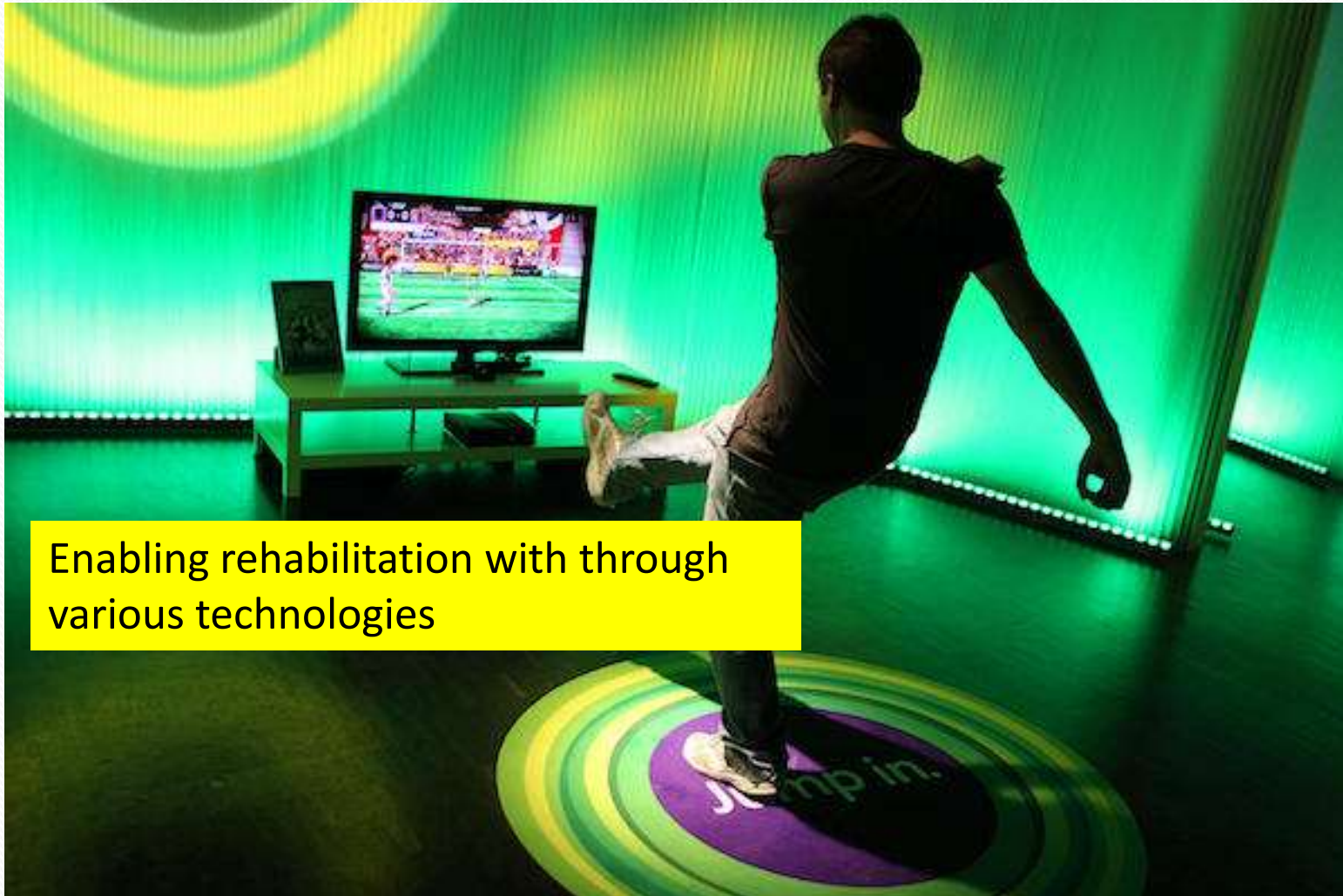

Enabling rehabilitation with through various technologies

Rotary

District 9940

LOWER HALF OF THE NORTH ISLAND, NEW ZEALAND



Over the last 4 years, 12 Clubs in district 9940 have been involved with 32 donations/fundraising programmes for Wellington Regional Children's Hospital





Come on this journey with us.....

- We would welcome working with Rotary District 9440 on a major part of this “once in a life time project”.
- This would be a major Rotary contribution and partnership with our Region’s young children’s health where Rotary will be wonderfully recognised.





Wellington



**HOSPITALS
FOUNDATION**

whf.org.nz